

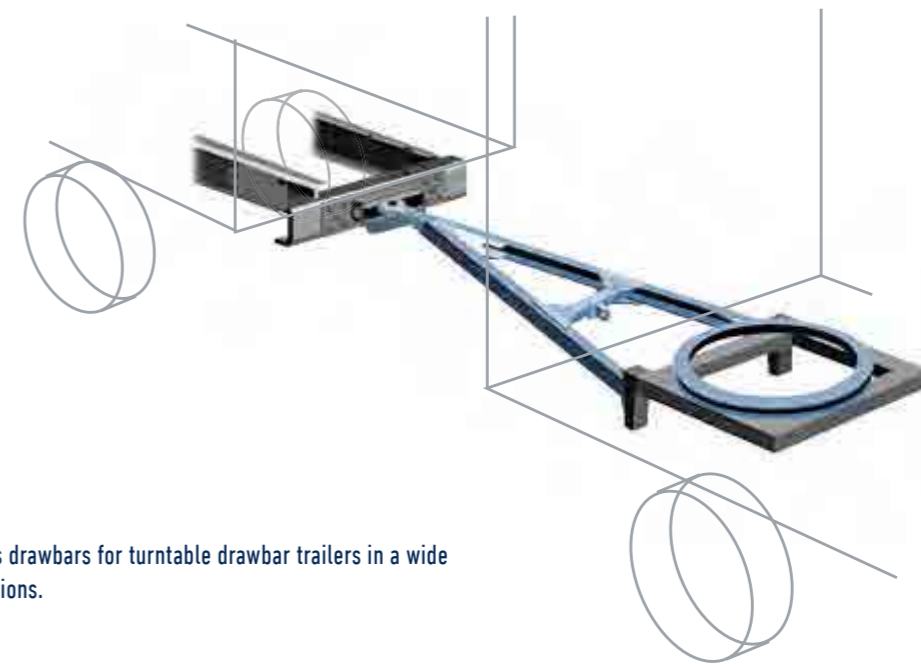

## The perfect combination for turntable drawbar trailers. Drawbars from BPW.

BPW drawbars for turntable drawbar trailers with a permissible gross weight of 12 to 48 t form the perfect link between tractor units and trailers with turntable steering. BPW supplies all the versions that are required in practice, such

as straight or angled towing eyes, or with length adjustment and/or cranked. In addition to this, all BPW standard drawbars have ECE approval and special versions are type approved.



BPW supplies drawbars for turntable drawbar trailers in a wide range of versions.

### BPW DRAWBARS – FEATURES AND BENEFITS

- ▶ For turntable drawbar trailers with a permissible gross weight of 12 to 48 t
- ▶ Common dimensions are available immediately
- ▶ With ECE approval or individual certificate
- ▶ Treated with zinc phosphate, with cathoretic dip-coating (KTL<sub>zn</sub>)
- ▶ High level of corrosion resistance due to galvanized towing bars on length-adjustable drawbars
- ▶ Various versions available:
  - ▶ With angled towing eye
  - ▶ With fixed centre tube
  - ▶ Straight or cranked
  - ▶ Length adjustable
  - ▶ With swivelling eye
  - ▶ With semi-automatic or pneumatic length adjustment
  - ▶ With low-maintenance silent bushes

# BPW drawbars up to 48,000 kg

## TBZ series made of U normal profile

(ECE approval)

The TBZ 27 and 32 series have towing eyes with  $\varnothing$  40 mm (DIN 74054-40A) as standard. All drawbars are also available with towing eyes  $\varnothing$  50 mm (DIN 74053-50A). In all standard versions, the bearing eyes have plastic bushes. Other dimensions and towing eyes are available on request. Height adjustment devices from page 68.

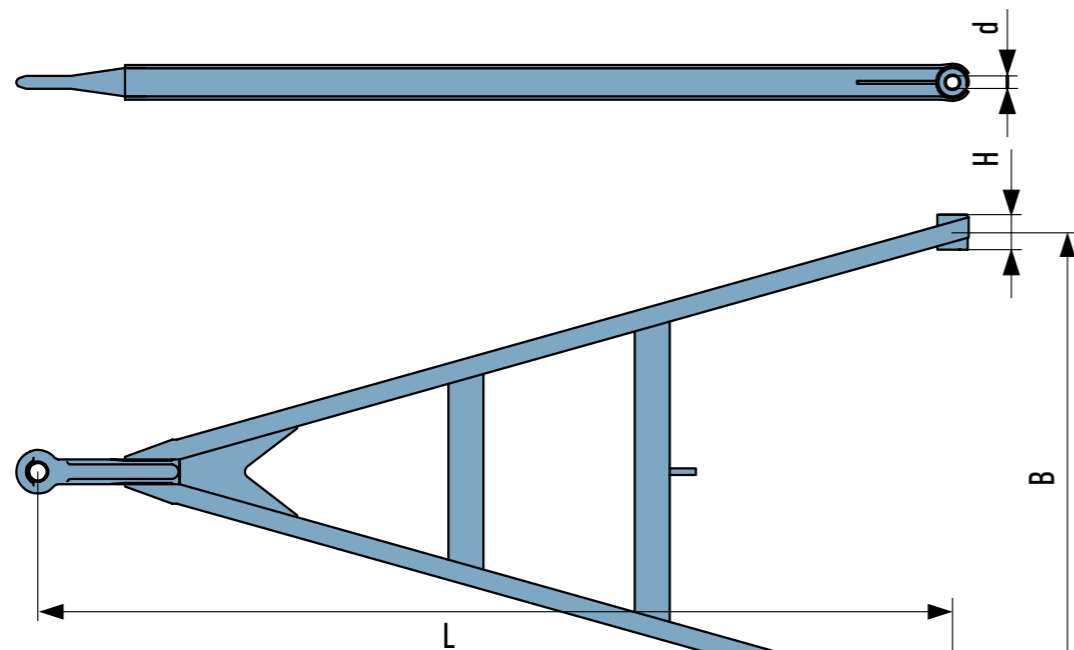

TYPE OF TOWING EYE	$\varnothing$ BUSH (mm)	TBZ 27	TBZ 32	TBZ 48
DIN 74054-40A/40B	40	•	•	
DIN 74053-50A/50B	50	•	•	•
VBG 15-0173/16-0895	57.5/50	•	•	•
NATO	76	•	•	•
Switzerland	40	•	•	
BNA (screw-in)	68	•	•	•
T56 heavy-duty towing eye	40			•

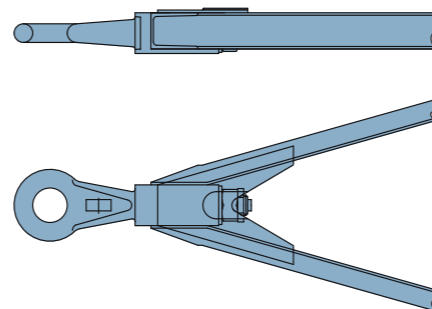

TBZ 27 drawbar also available with screw-in eye on request.

TYPE	LENGTH L (mm)	WIDTH AT CENTRE B (mm)	BEARING EYES H/d (mm)	CROSS STRUTS Quantity	WEIGHT Approx. kg
TBZ 27 D = 125 kN 27 t Max. front-axle load 12 t ECE no. E1-55R-012491 Profile U 80  Option of screw-in towing eye	1,100	860	100/30 <sup>1)</sup>  Special dimensions 70/26 80/28 80/30	1	31.0
	1,200				33.0
	1,300				35.0
	1,400				37.0
	1,500				39.0
	1,600				41.0
	1,700				42.5
	1,800				44.0
	1,900				45.5
	2,000				47.0
	2,100				51.0
	2,200				52.5
	2,300				54.0
	2,400				56.0
	2,500				58.0
	2,600				60.0
	2,700				61.5
2,800	63.0				
2,900	64.5				
3,000	66.0				
TBZ 32 D = 125 kN 32 t Max. front-axle load 16 t ECE no. E1-55R-012498 Profile U 100	1,400	330	100/30 <sup>1)</sup>  Special dimensions 70/26 80/28 80/30	1	41.0
	1,500				43.0
	1,600				45.0
	1,700				47.0
	1,800				49.0
	1,900				51.0
	2,000				53.0
	2,100				56.0
	2,200				60.0
	2,300				62.0
	2,400				64.0
	2,500				66.0
	2,600				68.0
	2,700				70.0
	2,800				72.0
	2,900				74.0
	3,000				76.0
TBZ 482) D = 190 kN 48 T Max. front-axle load 24 t ECE NO. E1-55R-012497 Profile U 120	1,500	860	100/30 <sup>1)</sup>  Special dimensions 102/32 <sup>3)</sup> 100/35 100/40 <sup>4)</sup>	1	62.0
	1,600				64.5
	1,700				67.0
	1,800				69.5
	1,900				72.0
	2,000				77.0
	2,100				79.0
	2,200				82.0
	2,300				85.0
	2,400				87.5
	2,500			90.0	
	2,600			93.0	
	2,700			98.0	
	2,800			100.5	
	2,900			103.0	
	3,000			105.5	
	3,100			108.0	
	3,200			111.0	
	3,300			114.0	
	3,400			116.0	
3,500	118.0				
				2	
				3	

<sup>1)</sup> Also available on request with low-maintenance silent bush (see page 60). <sup>2)</sup> Available with towing eye type 56 (heavy-duty towing eye) and type VBG as standard  
<sup>3)</sup> With Kronrohr block <sup>4)</sup> Brass bush

# BPW drawbars up to 27,000 kg SL series made from lightweight U profile

(ECE approval)

With towing eye Ø 40 mm (DIN 74054-40 A) as standard. All drawbars are also available with towing eye Ø 50 mm (DIN 74053-50 A). In all standard versions, the bearing eyes have plastic bushes. Other dimensions and towing eyes are available on request. Height adjustment devices from page 68.

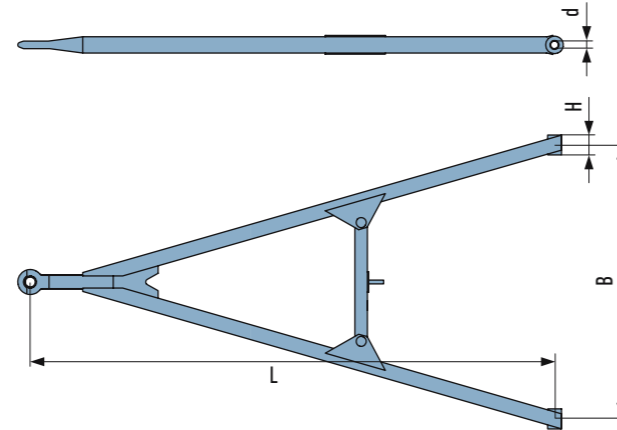

# BPW drawbars up to 32,000 kg ZGS series with angled towing eye

(ECE approval)

With towing eye Ø 40 mm (DIN 74054-40 A) as standard. All drawbars are also available with towing eye Ø 50 mm (DIN 74053-50 A). In all standard versions, the bearing eyes have plastic bushes. Other dimensions and towing eyes are available on request. Height adjustment devices from page 68.

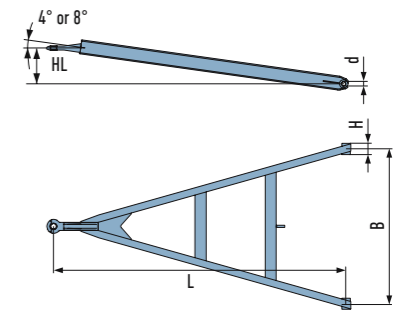

TYPE	LENGTH L (mm)	WIDTH AT CENTRE B (mm)	BEARING EYES H/d (mm)	CROSS STRUTS Quantity	HEIGHT OFFSET HL approx. mm (4°/8°)	WEIGHT Approx. kg
ZGS 27 D = 125 kN 27 t Max. front-axle load 12 t ECE no. E1-55R-012512 Profile UNP 80	1,400	600	100/30 <sup>1)</sup>  Special dimensions 70/26 80/28 80/30	1	84	37.0
	1,500				91	39.0
	1,600				98	41.0
	1,700				105	42.5
	1,800				112	44.0
	1,900				119	48.0
	2,000				126	49.5
	2			2,100	133	51.0
				2,200	140	52.5
				2,300	146	54.0
				2,400	153	56.0
				2,500	160	58.0
				2,600	167	60.0
				2,700	174	62.0
ZGS 32 D = 125 kN 32 t Max. front-axle load 16 t ECE no. E1-55R-012511 Profile UNP 100	1,400	600	100/30 <sup>1)</sup>  Special dimensions 70/26 80/28 80/30	1	84	41.0
	1,500				91	43.0
	1,600				98	45.0
	1,700				105	47.0
	1,800				112	49.0
	1,900				119	51.0
	2,000				126	53.0
	2			2,100	133	56.0
				2,200	140	60.0
				2,300	146	62.0
				2,400	153	64.0
				2,500	160	66.0
				2,600	167	68.0
				2,700	174	70.0
ZGS 48 <sup>2)</sup> D = 190 kN 48 t Max. front-axle load 20 t Individual certificate Profile UNP 120	1,400	860	1100/30 <sup>1)</sup>  Special dimensions 102/32 <sup>3)</sup> 100/35 100/40 <sup>4)</sup>	1	84	59.5
	1,500				91	62.0
	1,600				98	64.5
	1,700				105	67.0
	1,800				112	69.5
	1,900				119	74.5
	2,000				126	77.0
	2			2,100	133	79.0
				2,200	140	82.0
				2,300	146	85.0
				2,400	153	87.5
				2,500	160	90.0
				2,600	167	93.0
				2,700	174	96.0

TYPE	LENGTH L (mm)	WIDTH AT CENTRE B (mm)	BEARING EYES H/d (mm)	CROSS STRUTS Quantity	WEIGHT Approx. kg
SL 12 D = 82.4 kN 12 t Max. front-axle load 6 t ECE no. E1-55R-012506 Profile 65/57.5/4	1,400	800	100/30 <sup>1)</sup>  Special dimensions 70/26 80/28 80/30	1	27.0
	1,500				28.0
	1,600				29.0
	1,700				30.0
	1,800				31.0
	1,900				32.0
	2,000				33.0
	2,100				34.0
	2,200				35.0
SL 27 D = 125 kN 27 t Max. front-axle load 12 t ECE no. E1-55R-012508 Profile 80/70/6	1,400	800	100/30 <sup>1)</sup>  Special dimensions 70/26 80/28 80/30	1	37.0
	1,500				39.0
	1,600				41.0
	1,700				42.5
	1,800				44.0
	1,900				45.5
	2,000				47.0
	2			2,100	49.0
				2,200	50.0
				2,300	52.0
				2,400	54.0
				2,500	56.0
				2,600	58.0
				2,700	62.0
2	2,800	64.0			
	2,900	66.0			
	2,900	68.0			

<sup>1)</sup> Also available on request with low-maintenance silent bush (see page 60).

<sup>1)</sup> Also available on request with low-maintenance silent bush (see page 60). <sup>2)</sup> Available with towing eye type 56 (heavy-duty towing eye). <sup>3)</sup> With Kronrohr block. <sup>4)</sup> Brass bush.

# BPW drawbars up to 26,000 kg PZM series with fixed centre tube

(ECE approval)

With towing eye Ø 40 mm (DIN 74054-40 A) as standard. All drawbars are also available with towing eye Ø 50 mm (DIN 74053-50 A). In all standard versions, the bearing eyes have plastic bushes. Other dimensions and towing eyes are available on request. Height adjustment devices from page 68.

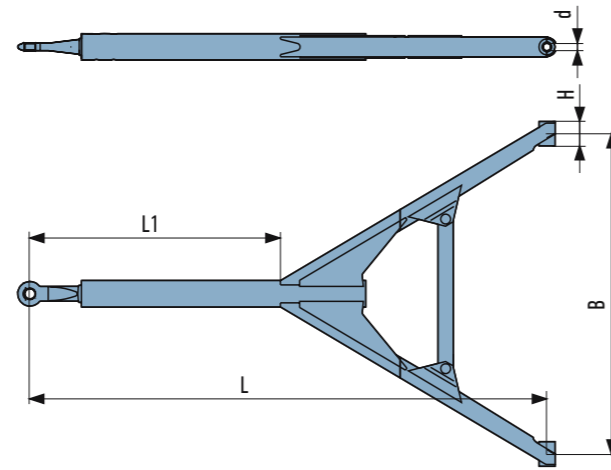

TYPE	LENGTH L (mm)	WIDTH AT CENTRE B (mm)	BEARING EYES H/d (mm)	LENGTH L1 (mm)	CROSS STRUTS Quantity	WEIGHT Approx. kg
<b>PZM 26</b> D = 125 kN 26 t Max. front-axle load 10 t ECE no. E1-55R-012.500 Profile U 80/70/6 Towing bar Ø 108	1,600	860	100/30 <sup>1)</sup>  Special dimen- sions 80/28 80/30	740	1	70.0
	1,700			75.0		
	1,800			77.0		
	1,900			79.0		
	2,000			81.0		
	2,100			82.5		
	2,200			84.0		
	2,300			87.0		
	2,400			89.0		
	2,500			91.0		
	2,600			94.0		
	2,700			95.5		
	2,800			97.0		
	2,900			101.0		
	3,000			103.0		
	3,100			105.0		
	3,200			107.0		
	3,300			109.0		
3,400	112.0					

<sup>1)</sup> Also available on request with low-maintenance silent bush (see page 60).

# BPW drawbars up to 26,000 kg PZMS series with fixed centre tube and angled towing eye

(Individual certificate)

With towing eye Ø 40 mm (DIN 74054-40 A) as standard. All drawbars are also available with towing eye Ø 50 mm (DIN 74053-50 A). In all standard versions, the bearing eyes have plastic bushes. Other dimensions and towing eyes are available on request. Height adjustment devices from page 68.

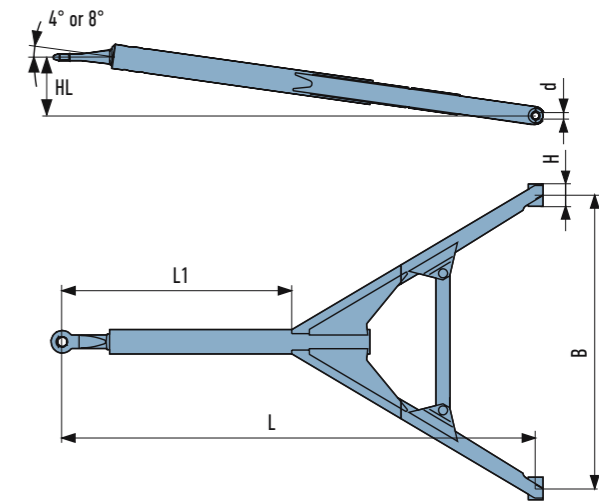

TYPE	LENGTH L (mm)	WIDTH AT CENTRE B (mm)	BEARING EYES H/d (mm)	LENGTH L1 (mm)	CROSS STRUTS Quantity	HEIGHT OFFSET HL APPROX. MM (4°/8°)	WEIGHT Approx. kg
<b>PZMS 26</b> D = 125 kN 26 t Max. front-axle load 10 t ECE no. E1-55R-012.500 Profile U 80/70/6 Towing bar Ø 108	1,600	860	100/30 <sup>2)</sup>  Special dimen- sions 80/28 80/30	740	1	97	70.0
	1,700			104		209	75.0
	1,800			111		223	77.0
	1,900			118		237	79.0
	2,000			125		251	81.0
	2,100			132		265	82.5
	2,200			139		280	84.0
	2,300			146		294	87.0
	2,400			153		308	89.0
	2,500			160		322	91.0
	2,600			167		336	94.0
	2,700			174	350	95.5	
	2,800			181	364	97.0	
	2,900			188	378	101.0	
	3,000			195	392	103.0	
	3,100			202	406	105.0	
	3,200			209	420	107.0	
	3,300			218	434	109.0	
	3,400			223	448	112.0	

<sup>2)</sup> Also available on request with low-maintenance silent bush (see page 60).

# BPW drawbars up to 40,000 kg

## PZS series with swivelling eye

(Individual certificate)

Available as standard with swivelling towing eye Ø 40 mm (DIN 74054-40 A) and towing eye Ø 50 mm (DIN 74053-50 A). In all standard versions, the bearing eyes have plastic bushes. Other dimensions and towing eyes are available on request. Height adjustment devices from page 68.

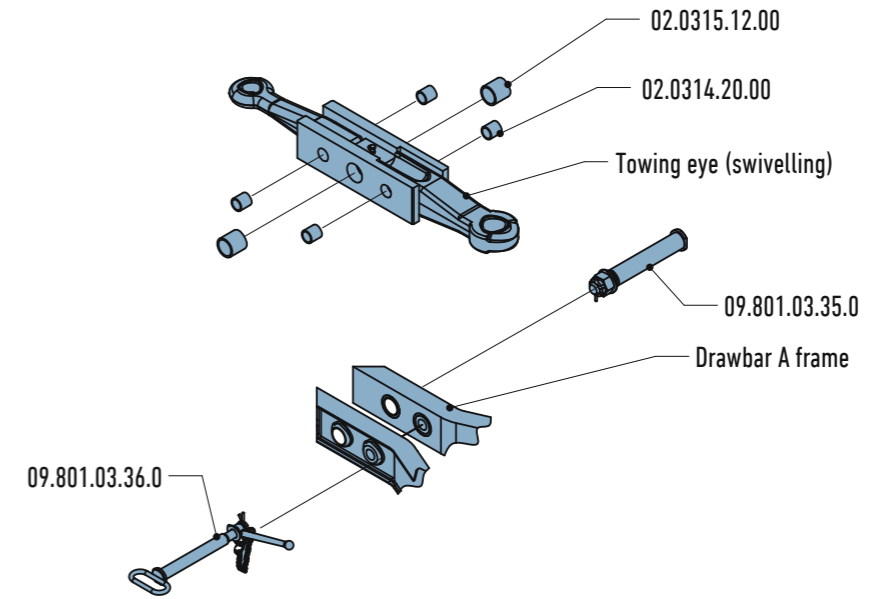
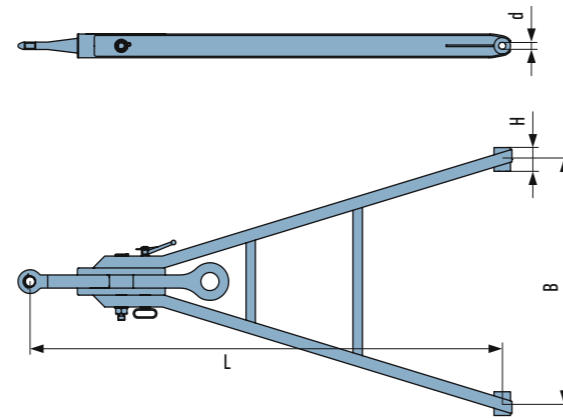

TYPE	LENGTH L (mm)	WIDTH AT CENTRE B (mm)	BEARING EYES H/d (mm)	CROSS STRUTS Quantity	WEIGHT Approx. kg			
PZS 26 D = 125 kN <sup>1)</sup> 26 t Max. front-axle load 10 t Individual certificate Profile UNP 80	1,400	900	100/30 <sup>2)</sup>  Special dimensions available on request	1	71			
	1,500				73			
	1,600				75			
	1,700				77			
	1,800				79			
	1,900				81			
	PZS 32 D = 125 kN <sup>1)</sup> 32 t Max. front-axle load 12 t Individual certificate Profile UNP 100			2,000	900	100/30 <sup>2)</sup>  Special dimensions available on request	2	84
				2,100				86
				2,200				88
				2,300				90
				2,400				92
				2,500				94
				2,600			96	
2,700		98						
PZS 32 D = 125 kN <sup>1)</sup> 32 t Max. front-axle load 12 t Individual certificate Profile UNP 100		1,400	900	100/30 <sup>2)</sup>  Special dimensions available on request			1	77
		1,500						79
	1,600	81						
	1,700	83						
	1,800	85						
	1,900	87						
	PZS 32 D = 125 kN <sup>1)</sup> 32 t Max. front-axle load 12 t Individual certificate Profile UNP 100	2,000			900	100/30 <sup>2)</sup>  Special dimensions available on request	2	90
		2,100						92
		2,200						94
		2,300						96
		2,400						98
		2,500						100
		2,600						102
2,700	104							

<sup>1)</sup> The value depends on the selected towing eye combination (e.g. FBS max. 95 kN; NATO max. 120 kN).  
<sup>2)</sup> Also available on request with low-maintenance silent bush (see page 60).

TYPE	LENGTH L (mm)	WIDTH AT CENTRE B (mm)	BEARING EYES H/d (mm)	CROSS STRUTS Quantity	WEIGHT Approx. kg			
PZS 40 <sup>3)</sup> D = 175 kN <sup>4)</sup> 40 t Max. front-axle load 2x 10 t Individual certificate Profile UNP 120	1,600	900	100/30 <sup>5)</sup>  Special dimensions available on request	1	90			
	1,700				93			
	1,800				95			
	1,900				98			
	2,000				102			
	2,100				105			
	PZS 40 <sup>3)</sup> D = 175 kN <sup>4)</sup> 40 t Max. front-axle load 2x 10 t Individual certificate Profile UNP 120			2,200	900	100/30 <sup>5)</sup>  Special dimensions available on request	2	107
				2,300				110
				2,400				112
				2,500				115
				2,600				117
				2,700				120

<sup>3)</sup> Available as standard with swivelling towing eye DIN 40 and type 56 (heavy-duty towing eye). <sup>4)</sup> The value depends on the selected towing eye combination (e.g. Ø 40 max. 125 kN; FBS max. 95 kN). <sup>5)</sup> Also available on request with low-maintenance silent bush (see page 60).

SPARE PARTS FOR PZS AND PZSG	QUANTITY	BPW NO.
Silent bush 100/30	2	02.0316.06.00
Plastic bush 100/30	4	02.0315.22.00
Bolt 40 with castle nut, washer and split pin (retaining bolt)	1	09.801.03.35.0
Bolt 26 with locking handle, spring plug and chain (lock bolt)	1	09.801.03.36.0
Bush for lock bolt	4	02.0314.20.00
Bush for retaining bolt	2	02.0315.12.00
Towing eye 40/towing eye 50 swivelling	1	05.398.02.49.0
Towing eye 40/towing eye type 56 swivelling	1	05.398.02.28.0
Towing eye 40/FBS towing eye swivelling	1	05.398.40.14.0
Towing eye 40/NATO towing eye, swivelling	1	05.398.33.13.0
Towing eye 50/NATO towing eye, swivelling	1	05.398.02.50.0
Towing eye 40/towing eye 57.5 VBG15, swivelling	1	05.398.31.28.0

For towing eye types, see page 36.



# BPW drawbars up to 48,000 kg

## PZSG series with swivelling eye and cranked

(Individual certificate)

Available as standard with swivelling towing eye Ø 40 mm (DIN 74054-40A) and heavy-duty towing eye Ø 50 mm (type 56), cranked h = 150 mm.

In all standard versions, the bearing eyes have plastic bushes. Other dimensions and towing eyes are available on request. Height adjustment devices from page 68.

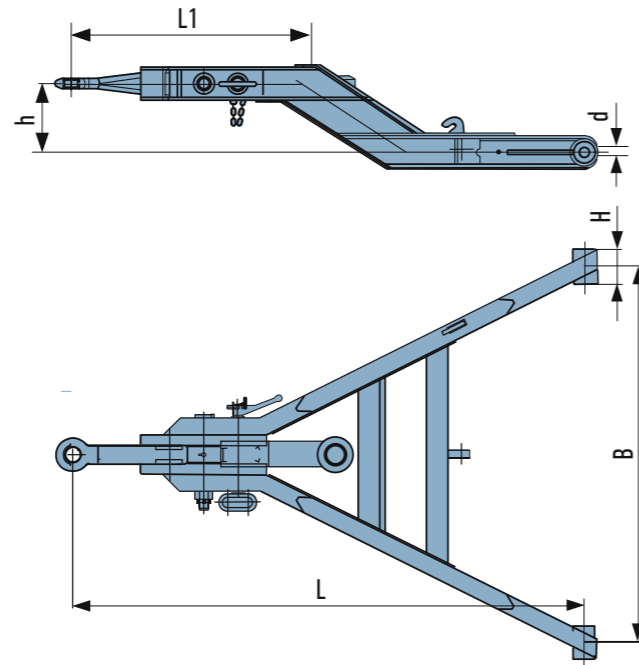

TYPE	LENGTH L (mm)	WIDTH AT CENTRE B (mm)	BEARING EYES H/d (mm)	LENGTH L1 (mm)	CROSS STRUTS Quantity	CRANKED h (mm)	WEIGHT Approx. kg		
<b>PZSG 48</b> D = 125/168 kN 48 t Max. front-axle load 24 t Individual certificate Profile UNP 100	1,400	860	100/30 <sup>1)</sup> Special dimensions available on request	700	2	150	98		
	1,500						100		
	1,600						102		
	1,700						104		
	1,800						106		
	1,900						108		
	2,000			800	250	200	2	250	110
	2,100								112
	2,200								114
	2,300								116
	2,400								118
	2,500								120
	2,600								122

<sup>1)</sup> Also available on request with low-maintenance silent bush (see page 60).

# BPW drawbars up to 48,000 kg

## PZG series, cranked

(With ECE approval or individual certificate)

**PZG 18:** with towing eye Ø 40 mm (DIN 74054-40 A) as standard

**PZG 32:** with towing eye Ø 40 mm (DIN 74054-40 A) and cranked h = 150 mm as standard. All drawbars are also available with towing eye Ø 50 mm (DIN 74053-50 A)

**PZG 48:** with heavy-duty towing eye Ø 50 mm (type 56) as standard

In all standard versions, the bearing eyes have plastic bushes. Other dimensions and towing eyes are available on request. Height adjustment devices from page 68.

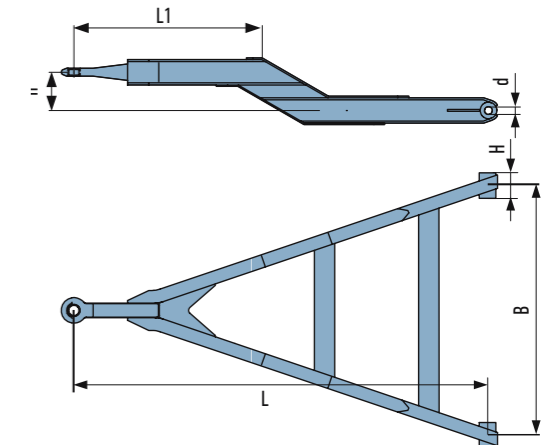

TYPE	LENGTH L (mm)	WIDTH AT CENTRE B (mm)	BEARING EYES H/d (mm)	LENGTH L1 (mm)	CROSS STRUTS Quantity	CRANKED H (mm)	WEIGHT Approx. kg		
<b>PZG 18</b> D = 100 kN 18 t Max. front-axle load 9 t Individual certificate Profile UNP 80 (for h = 150)	1,400	860	100/30 Special dimensions 70/26 80/28 80/30	600	1	150	53		
	1,500						55		
	1,600						57		
	1,700						59		
	1,800						61		
	1,900						63		
	2,000			700	250	2	200	250	65
	2,100								67
	2,200								70
	2,300								73
	2,400								76
	2,500								80
	2,600								83
2,700	87								
2,800	90								
2,900	93								

						<b>PZG 32</b>	<b>PZG 48</b>			
<b>PZG 32</b> D = 125 kN 32 t Max. front-axle load 20 t (dependent on L!) ECE no. E1-55R-012514 Profile UNP 100	1,400 1,500 1,600 1,700 1,800 1,900 2,000 2,100 2,200 2,300 2,400 2,500 2,600 2,700 2,800 2,900 3,000	860	100/30 <sup>1)</sup> Special dimensions 70/26 80/28 80/30	600	1	150	58,0			
							60,0	69,0		
							62,0	72,0		
							65,0	75,0		
							67,0	78,0		
							69,0	81,0		
				71,0	700	250	2	200	250	84,0
				76,0						89,0
				78,0						92,0
				81,0						94,5
				83,0						97,0
				86,0						99,5
				88,0						102,0
91,0	105,0									
93,0	108,0									
96,0	111,0									
-	114,0									

<sup>1)</sup> Also available on request with low-maintenance silent bush (see page 60).

# BPW drawbars up to 48,000 kg

## PZGL series, cranked and length-adjustable

(With ECE approval or individual certificate)

**PZGL 32:** with towing eye Ø 40 mm (DIN 74054-40 A), cranked h = 150 mm and length adjustment 12 x 50 mm as standard. All drawbars are also available with towing eye Ø 50 mm (DIN 74053-50 A). Also available with locking nuts on request (version V)

**PZGL 48:** with heavy-duty towing eye Ø 50 mm (type 56) as standard

In all standard versions, the bearing eyes have plastic bushes. Other dimensions and towing eyes are available on request. Height adjustment devices from page 68.

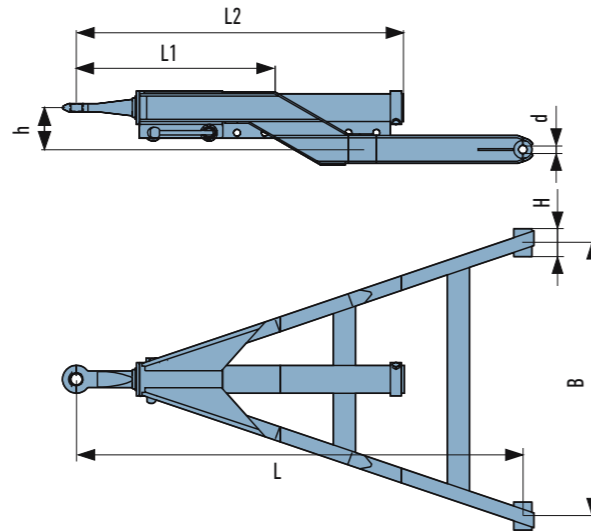

# BPW drawbars up to 32,000 kg

## PZLG 32 series, length-adjustable and cranked (towing bar)

(Individual certificate)

With towing eye Ø 40 mm (DIN 74054-40 A), cranked h = 150 mm and length adjustment 12 x 50 mm as standard. All drawbars are also available with towing eye Ø 50 mm (DIN 74053-50 A). Also available with locking nuts on request (version V). In all standard versions, the bearing eyes have plastic bushes. Other dimensions and towing eyes are available on request. Height adjustment devices from page 68.

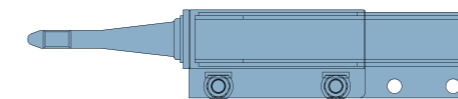
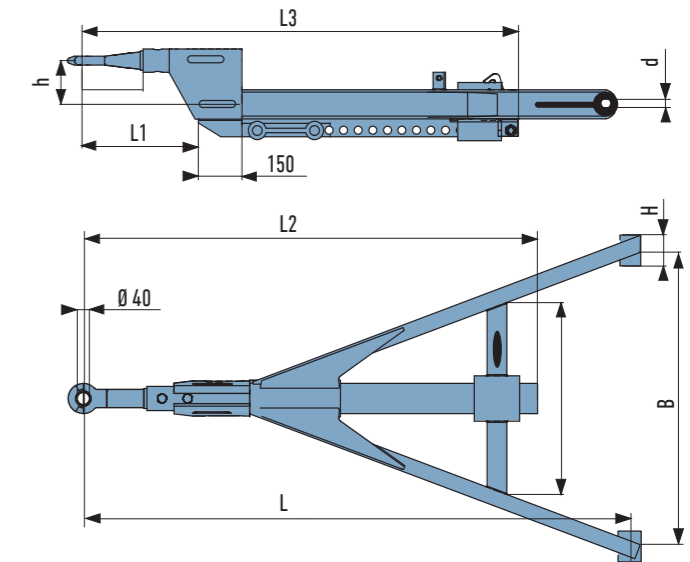

Standard adjustable version 'E'  
(with bolt and nut)

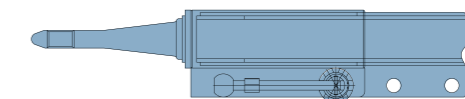

Optional at the request of the customer: variable  
version 'V' (with bolt and locking nut)

TYPE	LENGTH L (mm)	WIDTH AT CENTRE B (mm)	BEARING EYES H/d (mm)	LENGTH L1 (mm)	EXTENSION L2 (mm)	CROSS STRUTS Quantity	WEIGHT Approx. kg
PZGL 32 D = 125 kN 32 t Max. front-axle load 10 t ECE no. E1-55R-012503 Profile UNP 100 Towing bar Ø 100	1,400	860	100/30 <sup>1)</sup> Special dimensions available on request	600	12 x 50 (L <sub>2</sub> = 1175)	1	106
	1,500						108
	1,600						110
	1,700						112
	1,800						114
	1,900						116
	2,000						118
	2,100						120
	2,200						124
	2,300						126
PZGL 48 <sup>2)</sup> D = 160 kN 48 t Max. front-axle load 24 t Individual certificate Profile UNP 100 Towing bar Ø 102	1,400	860	100/30 <sup>1)</sup> Special dimensions available on request	600	6 x 50 (L <sub>2</sub> = 875)	1	108
	1,500						110
	1,600						112
	1,700						114
	1,800						116
	1,900						118
	2,000						120
	2,100						126
	2,200						130
	2,300						132
PZGL 48 <sup>2)</sup> D = 160 kN 48 t Max. front-axle load 24 t Individual certificate Profile UNP 100 Towing bar Ø 102	1,400	860	100/30 <sup>1)</sup> Special dimensions available on request	700	8 x 50 (L <sub>2</sub> = 975)	2	132
	1,500						134
	1,600						136
	1,700						138
	1,800						132
	1,900						134
	2,000						136
	2,100						138
	2,200						132
	2,300						134
2,400	136						
2,500	138						
2,600	132						

<sup>1)</sup> Also available on request with low-maintenance silent bush (see page 60). <sup>2)</sup> Only version 'E' possible with adjustment (with nut and bolt).

TYPE	LENGTH L (mm)	WIDTH AT CENTRE B (mm)	BEARING EYES H/d (mm)	LENGTH L1 (mm)	EXTENSION L2 (mm)	CROSS STRUTS Quantity	WEIGHT Approx. kg						
PZLG 32 D = 120 kN 32 t Max. front-axle load 10 t Individual certificate Profile UNP 100	1,100	860	100/30 <sup>3)</sup> Special dimensions available on request	200	8 x 50 (L <sub>2</sub> = 1,100)	1	104						
	1,200						106						
	1,300						108						
	1,400						110						
	1,500						112						
	1,600						114						
	1,700						116						
	1,800						118						
	1,900						120						
	2,000						122						
	2,100						124						
	2,200						126						
	2,300						130						
	2,400						132						
	PZLG 32 D = 120 kN 32 t Max. front-axle load 10 t Individual certificate Profile UNP 100						1,100	860	100/30 <sup>3)</sup> Special dimensions available on request	400	12 x 50 (L <sub>2</sub> = 1,500)	2	126
							1,200						128
1,300		130											
1,400		132											
1,500		134											
1,600		136											
1,700		138											
1,800		132											
1,900		134											
2,000		136											

<sup>3)</sup> Also available on request with low-maintenance silent bush (see page 60).

# BPW drawbars up to 48,000 kg

## PZL series, length adjustable

(With ECE approval or individual certificate)

With towing eye Ø 40 mm (DIN 74054-40 A) and length adjustment 12 x 50 mm as standard. All drawbars are also available with towing eye Ø 50 mm (DIN 74053-50 A). Also available with locking nuts on request (version V).

In all standard versions, the bearing eyes have plastic bushes. Other dimensions and towing eyes are available on request. Height adjustment devices from page 68.

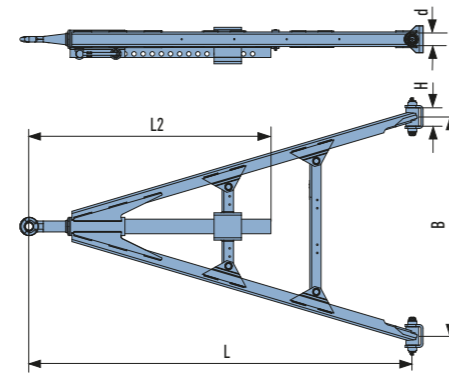

TYPE	LENGTH L (mm)	WIDTH AT CENTRE B (mm)	BEARING EYES H/d (mm)	EXTENSION L2 (mm)	CROSS STRUTS Quantity	WEIGHT Approx. kg
PZL 27 D = 125 kN 27 t Max. front-axle load 10 t ECE no. E1-55R-012501 Profile 80/70/6 Towing bar Ø 80	1,000	860	100/30 <sup>1)</sup>  Special dimensions 70/26 80/28 80/30	8 x 50 mm (L <sub>2</sub> = 975 mm)	1	80
	1,100			82		
	1,200			84		
	1,300			86		
	1,400			88		
	1,500			90		
	1,600			92		
	1,700			94		
	1,800			96		
	1,900			98		
	2,000			100		
	2,100			104		
	2,200			106		
	2,300			108		
2,400	110					
2,500	112					
2,600	114					
PZL 32 D = 125 kN 32 t Max. front-axle load 12 t Individual certificate Profile UNP 100 Towing bar Ø 100	1,100	860	100/30 <sup>1)</sup>  Special dimensions available on request	12 x 50 (L <sub>2</sub> = 1175 mm)	1	94
	1,200			96		
	1,300			98		
	1,400			100		
	1,500			102		
	1,600			104		
	1,700			106		
	1,800			108		
	1,900			110		
	2,000			116		
	2,100			118		
	2,200			120		
	2,300			122		
	2,400			124		
2,500	126					

Figures: Adjustable version 'E' (with bolt and nut) and variable version 'V' (with bolt and locking nut), see page 53.  
<sup>1)</sup> Also available on request with low-maintenance silent bush (see page 60).

**PZL 48:** with heavy-duty towing eye Ø 50 mm (type 56) and length adjustment 6 x 100 mm as standard. Also available with locking nuts on request (version V)

In all standard versions, the bearing eyes have plastic bushes. Other dimensions and towing eyes are available on request. Height adjustment devices from page 68.

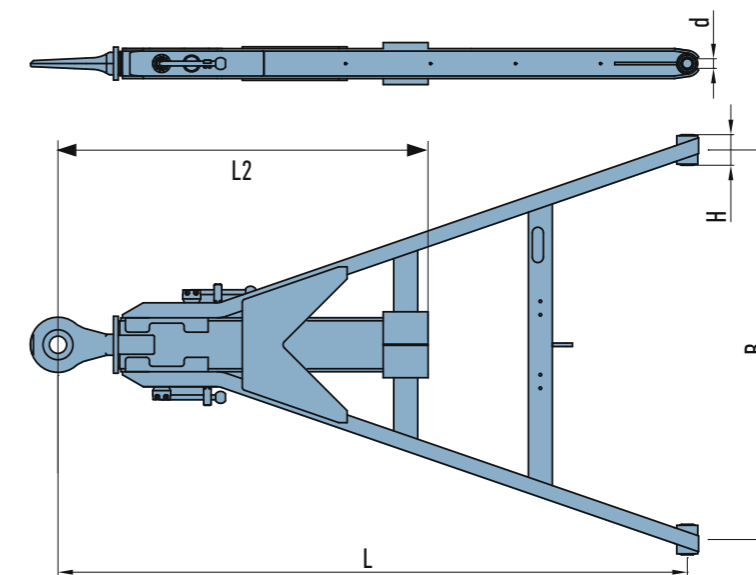

TYPE	LENGTH L (mm)	WIDTH AT CENTRE B (mm)	BEARING EYES H/d (mm)	EXTENSION L2 (mm)	CROSS STRUTS Quantity	WEIGHT Approx. kg
PZL 48 <sup>4)</sup> D = 190 kN 48 t Max. front-axle load 24 t ECE no. E1-55R-012502 Profile UNP 100	1,200	860	100/30 <sup>3)</sup>  Special dimensions 102/32 <sup>3)</sup> 100/35 100/40 <sup>4)</sup>	6 x 100 (L <sub>2</sub> = 1150 mm)	1	92
	1,300			95		
	1,400			97		
	1,500			99		
	1,600			101		
	1,700			103		
	1,800			105		
	1,900			107		
	2,000			109		
	2,100			115		
	2,200			117		
	2,300			120		
	2,400			122		
	2,500			125		
2,600	127					

<sup>3)</sup> Also available on request with low-maintenance silent bush (see page 60). <sup>4)</sup> Available with towing eye type 56 (heavy-duty towing eye) and type VBG as standard.  
<sup>5)</sup> With Kronrohr block <sup>6)</sup> With Brass bush.



# BPW drawbars up to 48,000 kg

## PML series, length adjustable, semi-automatic with automatic coupling or with pneumatic locking

(Individual certificate)

The PML series is specifically designed for greater front-axle loads and larger length adjustment. The adjustment is performed semi-automatically by hand at the automatic coupling or via a pneumatic locking device (optional).

The PML 32 has a towing eye  $\varnothing$  40 mm (DIN 74054-40A) and length adjustment of 8 x 100 mm as standard. The PML 48 has a towing

eye  $\varnothing$  57.5 mm (VBG 15-0173) and length adjustment of 4 x 150 mm as standard. In all standard versions, the bearing eyes have plastic bushes.

Other dimensions and towing eyes are available on request. Height adjustment devices from page 68.

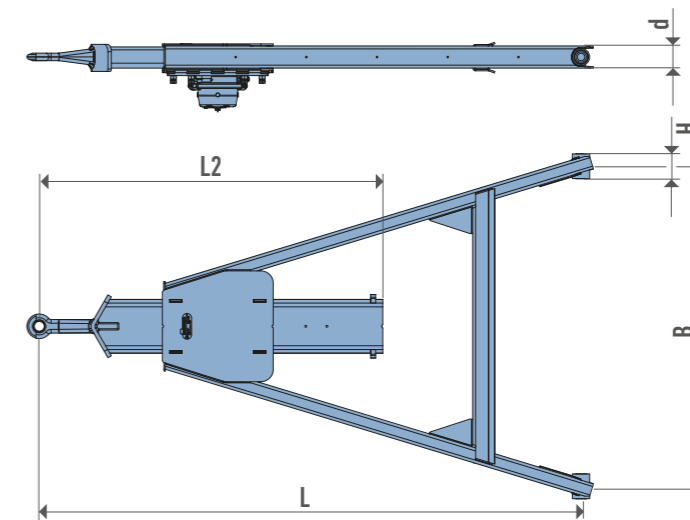
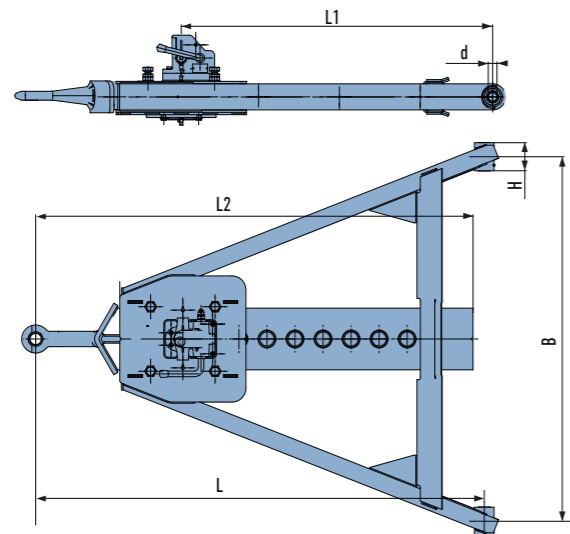

TYPE	LENGTH L (mm)	WIDTH AT CENTRE B (mm)	BEARING EYES H/d (mm)	EXTENSION L2 (mm)	CROSS STRUTS Quantity	WEIGHT Approx. kg
PML 32 D = 125 kN 32 t Max. front-axle load 12 t Individual certificate Profile 90/60/5	1,200	900	100/30 <sup>1)</sup>	8 x 100 1 x 100 + 1 x 900	1	160
	1,300					162
	1,400					164
	1,500					166
	1,600					168
	1,700					170
	1,800					172
	1,900					174
	2,000					176
	2,100					178
	2,200					180
	2,300					190
	2,400					192
	2,500					194
2,600	196					

TYPE	LENGTH L (mm)	WIDTH AT CENTRE B (mm)	BEARING EYES H/d (mm)	EXTENSION L2 (mm)	CROSS STRUTS Quantity	WEIGHT Approx. kg
PML 48 D = 165 kN 48 t Max. front-axle load 24 t Individual certificate Profile 90/60/6	1,200	900	100/30 <sup>1)</sup>	4 x 150 4 x 200	1	166
	1,300					169
	1,400					172
	1,500					175
	1,600					178
	1,700					181
	1,800					184
	1,900					187
	2,000					190
	2,100					193
	2,200					196
	2,300					210
	2,400					213
	2,500					216
2,600	219					

<sup>1)</sup> Also available on request with low-maintenance silent bush (see page 60). <sup>2)</sup> With Kronrohr block

<sup>1)</sup> Also available on request with low-maintenance silent bush (see page 60). <sup>2)</sup> With Kronrohr block

# BPW drawbars up to 26,000 kg

## LPS 26 series, length adjustable, semi-automatic with automatic coupling or with pneumatic locking

(Individual certificate)

**LPS 26 semi-automatic with automatic coupling:** The LPS 26 provides particularly convenient adjustment mechanism, with semi-automatic length adjustment. Unlocking is performed by hand with the automatic coupling. After 100 mm of adjustment travel, the coupling locks automatically. The towing bar can be adjusted by hand or by moving the tractor unit. Greater or different adjustment travel, e.g. 1 x 400 mm, can be implemented by using plugs in the towing bar.

**LPS 26 with pneumatic locking:** The locking and unlocking of the coupling bolt is performed using a button in the cab. This solution therefore provides a particularly convenient adjustment mechanism.

With towing eye  $\varnothing$  40 mm (DIN 74054-40 A) and length adjustment 4 x 100 mm as standard. All drawbars are also available with towing eye  $\varnothing$  50 mm (DIN 74053-50 A). In all standard versions, the bearing eyes have plastic bushes. Other dimensions and towing eyes are available on request. Height adjustment devices from page 68.

TYPE	LENGTH L (mm)	WIDTH AT CENTRE B (mm)	BEARING EYES H/d (mm)	LENGTH L2 (mm)	CROSS STRUTS Quantity	WEIGHT <sup>2)</sup> Approx. kg
LPS 26 D = 120 kN 26 t Max. front-axle load 10 t Individual certificate Profile 90/50/5	1,300	980	100/30 <sup>1)</sup>	4 x 100	1	122
	1,400					124
	1,500					126
	1,600					128
	1,700					130
	1,800					132
	1,900					134
Towing bar $\varnothing$ 100	2,000	1,400	80/28 80/30	4 x 100	2	136
	2,100					144
	2,200					146

<sup>1)</sup> Also available on request with low-maintenance silent bush (see page 60). locking +13 kg

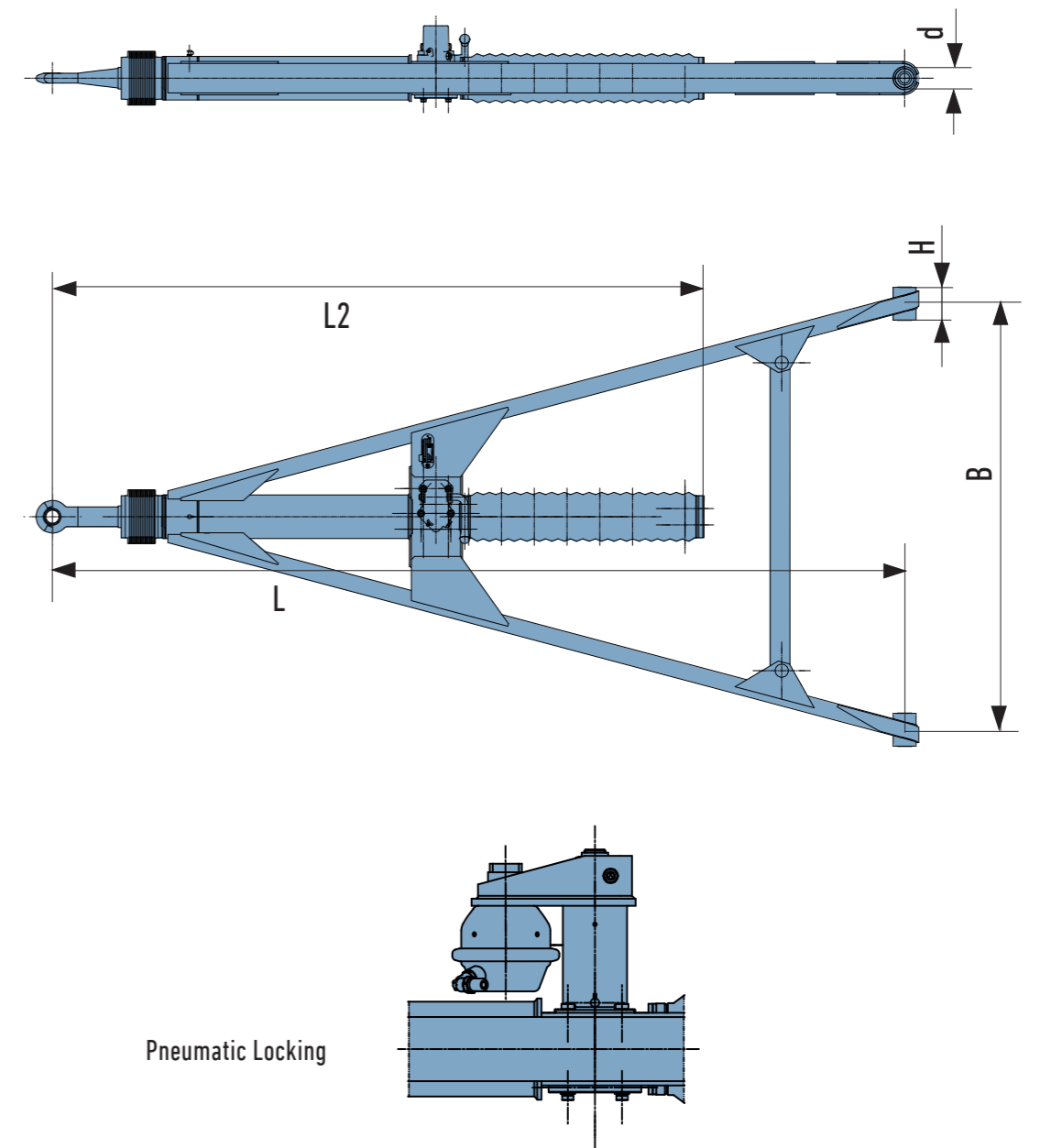

Pneumatic Locking

# BPW drawbars – general information

## Towing eyes and bushes

With its range of drawbars, BPW offers a comprehensive modular system that enables individual combinations. Below is an overview of the BPW standard product range.

### BPW TOWING EYES:

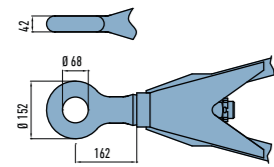

Screw-in towing eyes type BNA 29.05922  
D value = 200 kN

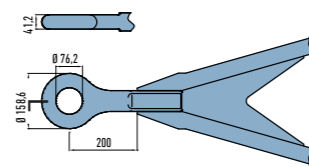

Towing eye type NATO VG-74059  
D value = 125 kN

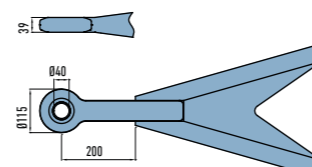

Towing eye: version for Switzerland  
D value = 168 kN

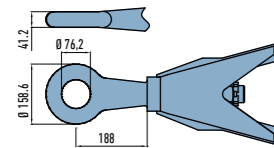

Screw-in towing eyes type NATO VG-74059  
D value = 125 kN

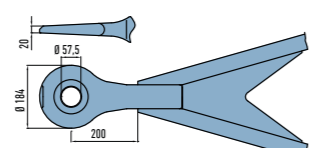

Towing eye VBG 15-173  
D value = 190 kN

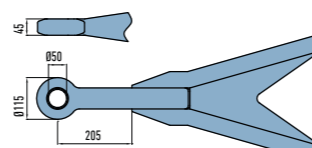

Towing eye VBG 16-0895  
D value = 190 kN

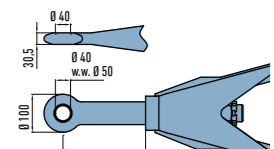

Screw-in towing eyes DIN 74054-40B  
Optionally DIN 74053-50B  
D value = 125 kN

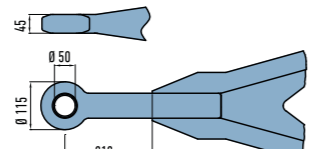

Towing eye in accordance with DIN 74053-50A  
D value = 130 kN  
Optionally towing eye type 56 similar to DIN 74053-50A  
D value = 260 kN

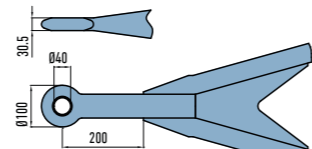

Towing eye similar to DIN 74054-40A  
With profile shaft  
Optionally towing eye DIN 74054-40A  
D value = 125 kN

### BPW BUSHES:

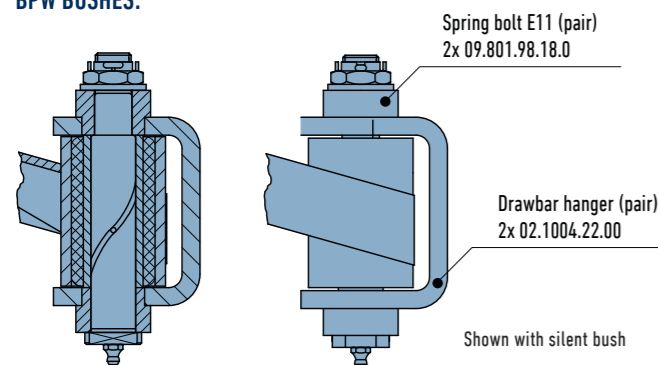

The dimensions for the bearing eye bushes can be found in the technical data sheets.

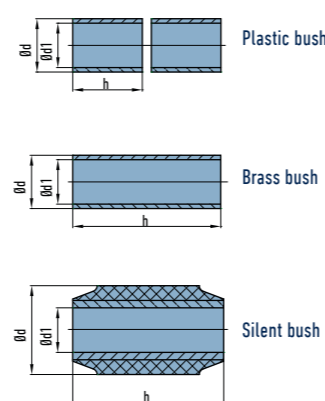

# BPW drawbars

## Spare parts

APPLICATION	DESIGNATION														BPW NO.				
	TBZ 27	TBZ 32	TBZ 48	SL 12	SL 27	ZGS 27	ZGS 32	PZM 26	PZMS 26	PZG 18	PZG 48	PZGL 32	PZL 27	PZL 32		PZL 48	PZLG 32		
<b>FOR BEARING EYE</b>	<b>NUMBER PER DRAWBAR</b>																		
Plastic bush 80/28	4x	4x	-	4x	4x	4x	-	4x	4x	4x	-	4x	4x	-	-	4x	02.0315.20.00		
Plastic bush 80/30	4x	4x	-	4x	4x	4x	4x	4x	4x	4x	4x	4x	4x	-	-	4x	02.0315.21.00		
Plastic bush 100/30	4x	4x	4x	4x	4x	4x	4x	4x	4x	4x	4x	4x	4x	4x	4x	4x	02.0315.22.00		
Silent bush 100/30	2x	2x	2x	2x	2x	2x	2x	2x	2x	2x	2x	2x	2x	2x	2x	2x	02.0316.06.00		
Brass bush 100/30	2x	2x	-	2x	2x	2x	2x	2x	2x	2x	2x	2x	2x	-	2x	2x	02.0315.17.00		
Brass bush 100/40	2x	2x	2x	-	2x	2x	-	-	-	2x	-	-	-	-	2x	2x	10.03.707258		
Kronrohr block	-	-	2x	-	-	-	-	-	-	-	-	-	-	-	-	2x	02.0314.13.00		
<b>Towing bar Ø 80 with towing eye 40</b>																			
Towing bar 12 x 50 length 1175	Adjustment opening 17														1x	09.028.45.02.0			
Towing bar 16 x 50 length 1375	Adjustment opening 21														1x	09.028.45.03.0			
<b>Towing bar Ø 80 with towing eye 50</b>																			
Towing bar 12 x 50 length 1175	Adjustment opening 17														1x	09.028.45.28.0			
Towing bar 16 x 50 length 1375	Adjustment opening 21														1x	09.028.45.17.0			
<b>Towing bar Ø 80 with towing eye CH</b>																			
Towing bar 12 x 50 length 1175	Adjustment opening 17														1x	09.028.45.52.0			
Towing bar 16 x 50 length 1375	Adjustment opening 21														1x	09.028.45.85.0			
<b>Towing bar Ø 80 with towing eye VBG-15</b>																			
Towing bar 12 x 50 length 1135	Adjustment opening 17														1x	09.028.45.95.0			
Towing bar 16 x 50 length 1335	Adjustment opening 21														1x	09.028.45.90.0			
<b>Towing bar Ø 100 with towing eye 40</b>																			
Towing bar 12 x 50 length 1175	Adjustment opening 17														1x	1x	09.028.51.02.0		
Towing bar 16 x 50 length 1375	Adjustment opening 21														1x	1x	09.028.51.08.0		
Towing bar offset 12 x 50 length 1,500 (from drawbar length 1,300)	Adjustment opening 17																1x	09.028.52.79.0	
<b>Towing bar Ø 100 with towing eye 50</b>																			
Towing bar 12 x 50 length 1175	Adjustment opening 17														1x	1x	09.028.51.09.0		
Towing bar 16 x 50 length 1375	Adjustment opening 21														1x	1x	09.028.51.10.0		
Towing bar offset 12 x 50 length 1,500 (from drawbar length 1,300)	Adjustment opening 17																1x	09.028.52.73.0	
<b>Towing bar Ø 100 with towing eye VBG-15</b>																			
Towing bar 12 x 50 length 1135	Adjustment opening 17														1x	1x	09.028.51.38.0		
<b>LOCKING MECHANISM</b>																			
<b>NUMBER PER DRAWBAR</b>																			
Bolt with locking nut version 'V' plus locking plates															2x	2x	2x	2	09.801.03.30.0
															2x	2x	2x	2	05.349.10.01.0
Bolt with nut version 'E' including locking washer															1x	1x	1x	1	05.801.90.13.0
																		2x	09.801.95.23.0
Bolt with locking nut version 'V' plus locking plates																		2x	05.349.10.01.0
																		1x	09.801.95.24.0

For PZS spare parts, see page 49. For LPS spare parts, see page 59.

## Spare Parts for PZL 27, PZL 32, PZGL 32

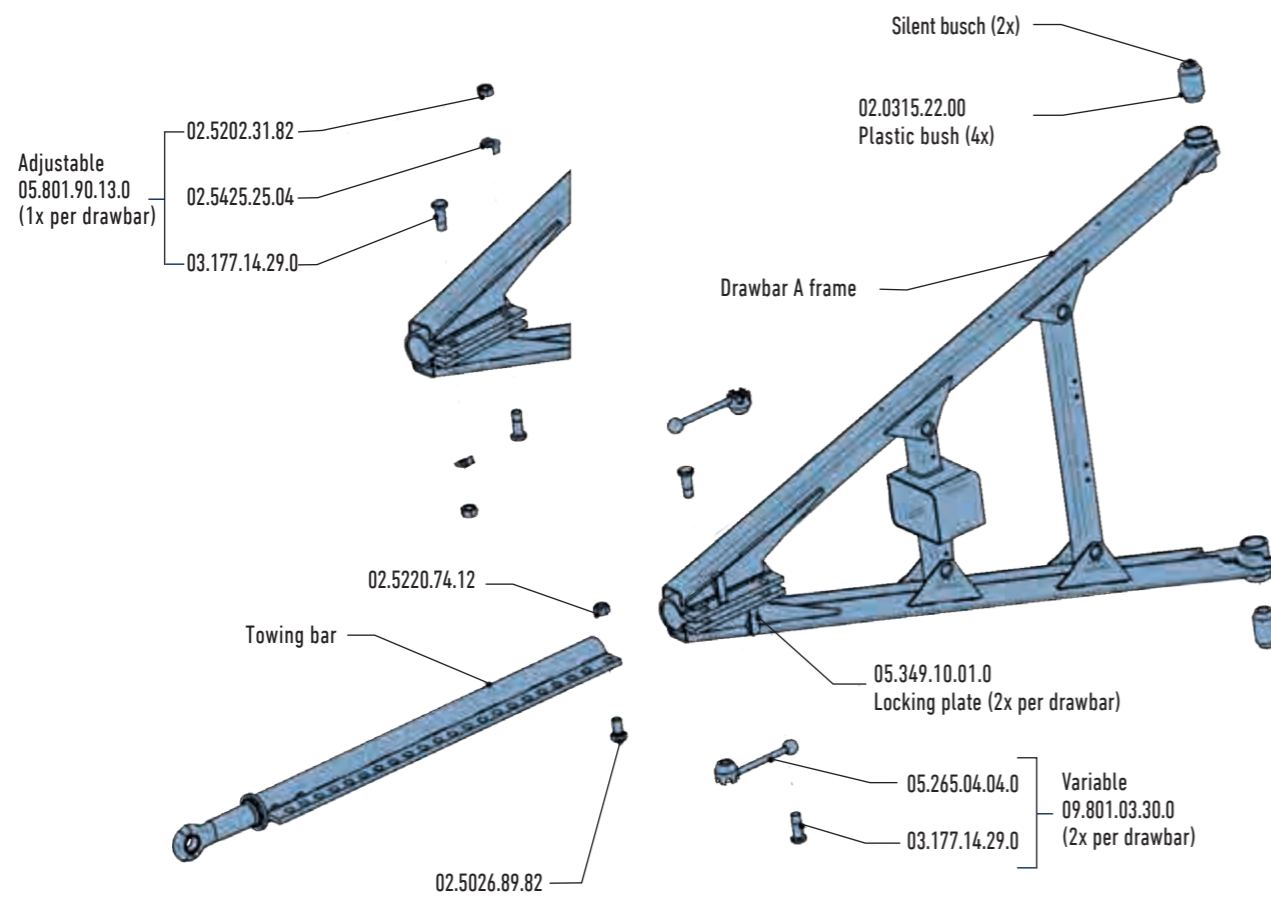

## Spare Parts for PZL 48

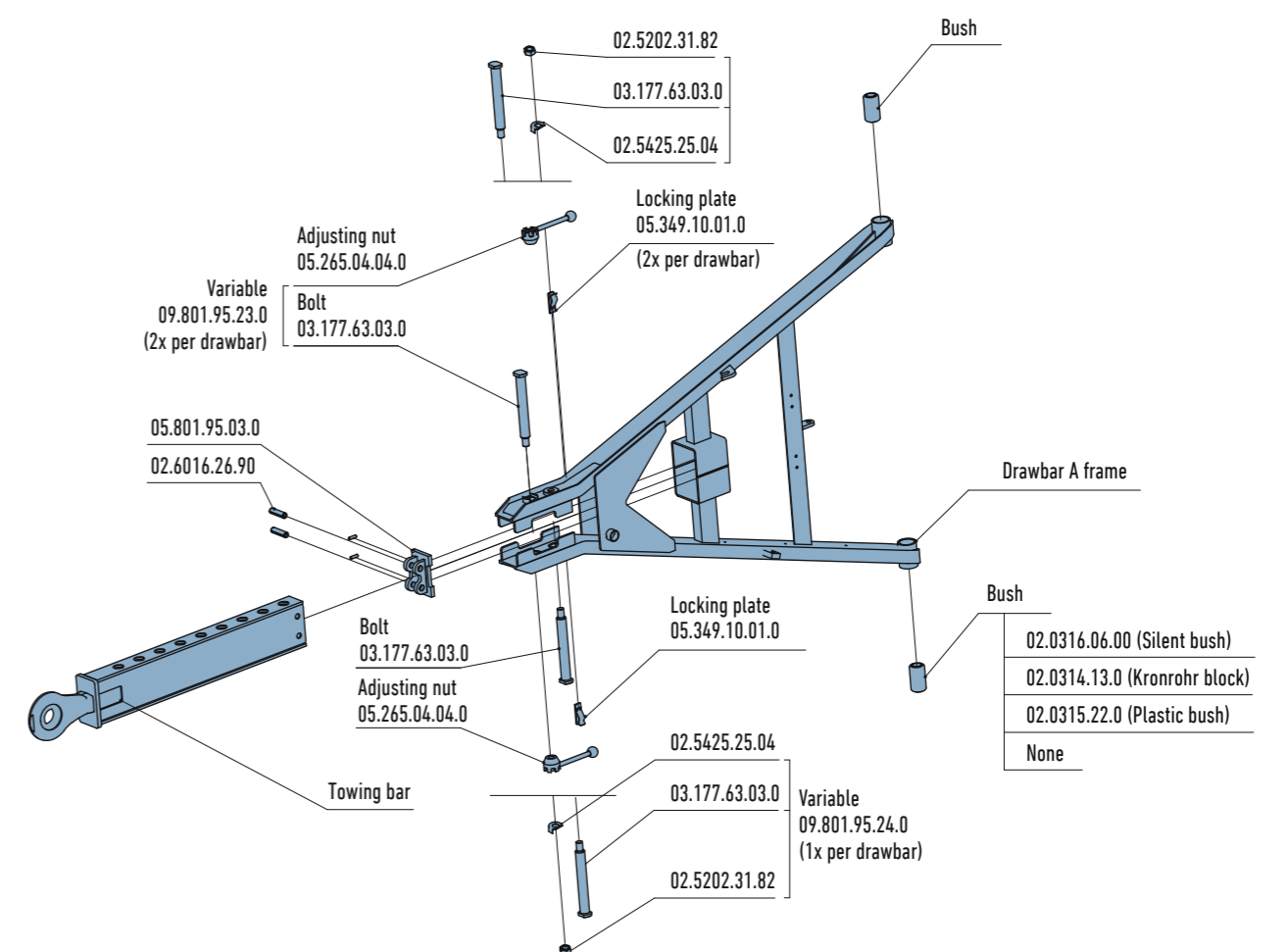

## Spare Parts for PML 32

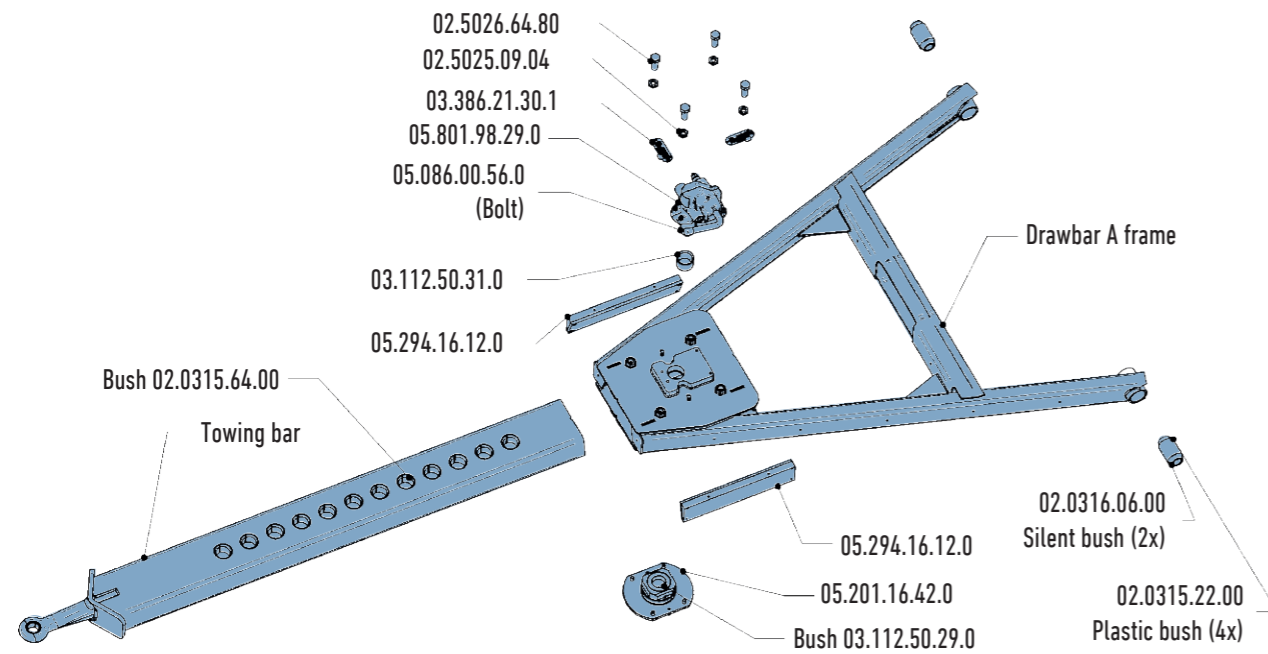

### SPARE PARTS FOR PML 32

SPARE PARTS FOR PML 32	QUANTITY	BPW NO.
Bush 60/49 x 39.5	1	03.112.50.31.0
Bush 80/49 x 40	1	03.112.50.29.0
Bush 60/50 x 47	1x per hole	02.0315.64.00
Coupling bolt 48.6 x 158	1	05.086.00.56.0
Automatic coupling	1	05.801.98.29.0
Guide rail Lg = 424	2	05.294.16.12.0
Adjustment bolt for guide rail (M20 x 50)	4	02.5026.64.80
Adjustment nut for guide rail (M20)	4	02.5205.09.04
Towing bar, complete, PML 32 towing eye DIN74054-40A 8 x 100	1	09.028.52.50.0
Plug PML 32	1x per hole	09.801.98.30.0
Silent bush 100/30	2	02.0316.06.00
Plastic bush 100/30	4	02.0315.22.00

## Spare Parts for PML 48

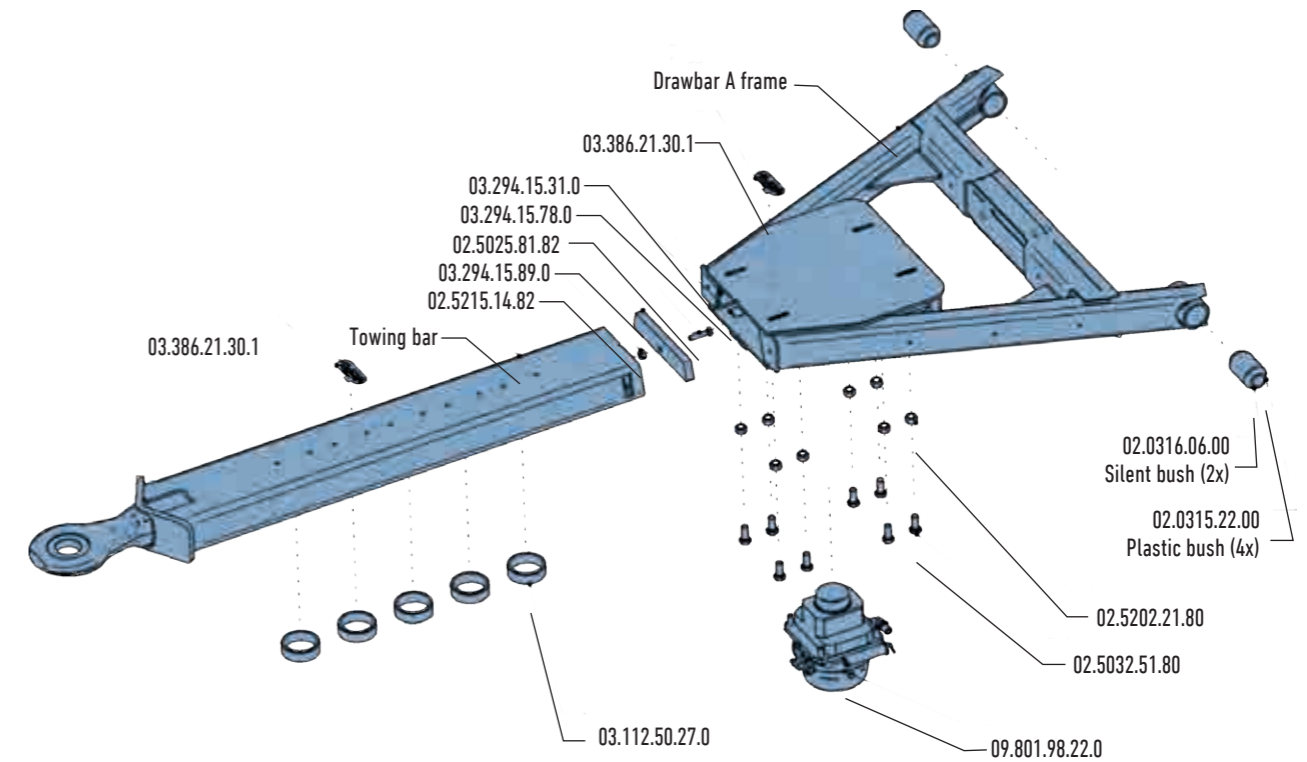

### SPARE PARTS FOR PML 48

SPARE PARTS FOR PML 48	QUANTITY	BPW NO.
Bush 90/80 x 28	1x per hole	03.112.50.27.0
Pneumatic locking (with sensor)	1	09.801.98.22.0
End stop 258 x 50 x 20	1	03.294.15.89.0
Hexagon screw for end stop	1	02.5025.81.82
Hexagon nut for end stop	1	02.5215.14.82
Bottom guide plate 100 x 34 x 10	4	03.294.15.78.0
Side guide plate 426 x 70 x 10	2	03.294.15.31.0
Adjustment bolt for guide plate (M16 x 1,5 x 35)	8	02.5032.51.80
Adjustment bolt for guide plate (M16 x 1,5)	8	02.5202.21.80
Silent bush 100/30	2	02.0316.06.00
Plastic bush 100/30	4	02.0315.22.00

# Spare Parts for LPS 26

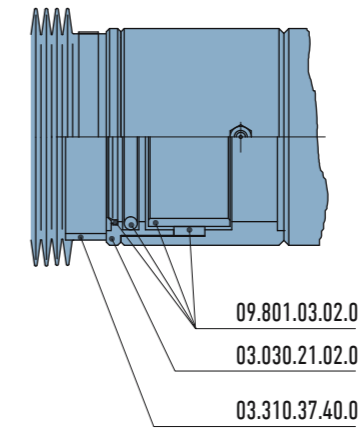
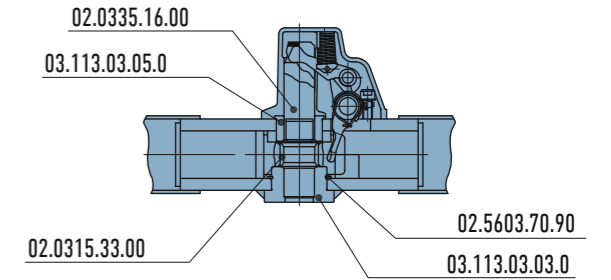
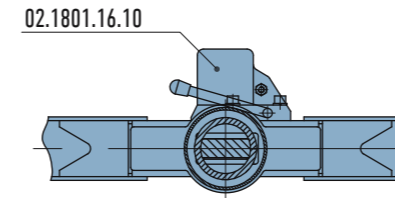
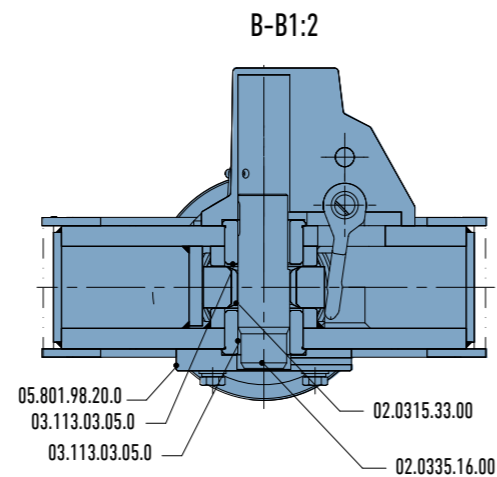
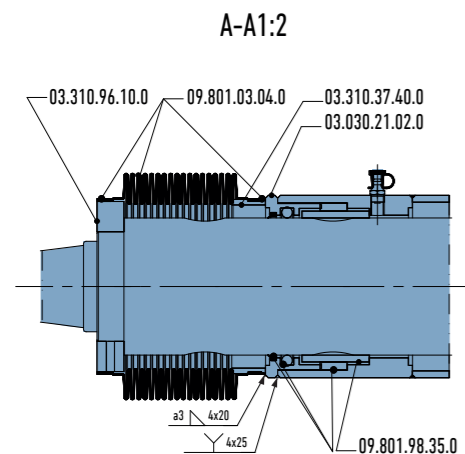
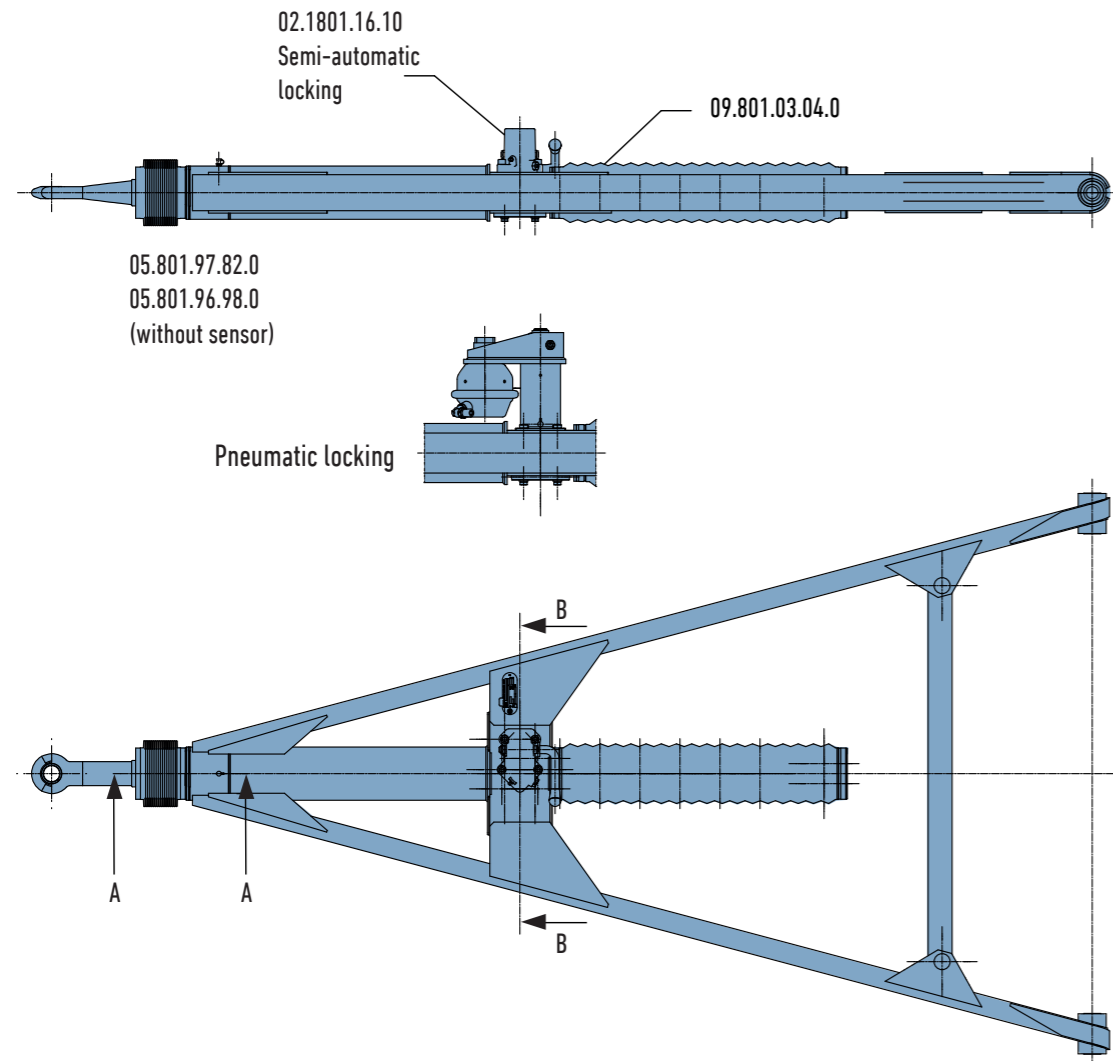

## SPARE PARTS FOR LPS 26

SPARE PARTS FOR LPS 26	QUANTITY	BPW NO.
Bush 62/38, 6 x 32 (from year of manufacture 09.2012)	2	03.113.03.05.0
Bush 62/38, 6 x 32 (until year of manufacture 08.2012)	1	03.113.03.05.0
Bush 34, 15 x 88 x 45 (until year of manufacture 08.2012)	1	03.113.03.03.0
Locking ring 70 x 2.5 x DIN 471 (until year of manufacture 08.2012)	1	02.5603.70.90
Bush 48.3/39 x 30	1x per hole	02.0315.33.00
Coupling bolt 38.5/34 x 129	1	02.0335.16.00
Automatic coupling	1	02.1801.16.10
Pneumatic locking (without sensor)	1	05.801.96.98.0
Pneumatic locking (with sensor)	1	05.801.97.82.0
Guide bearing set	1	09.801.03.02.0
Guide bearing	1	03.030.21.02.0
Weld-on ring for bellows	1	03.310.37.40.0
Ring 120/80 x 20	1	03.310.96.10.0
MT-TGRP bellows front and rear	2	09.801.03.17.0
Towing bar, complete, 100, towing eye DIN 74054 40A 4x 100	1	09.028.51.11.0
Towing bar, complete, 100, towing eye version CH 40 4x 100	1	09.028.51.14.0
Towing bar, complete, 100, towing eye DIN 74054 40A 6x 100	1	09.028.51.68.0
Towing bar, complete, 100, towing eye DIN 74054 40A adjustment 80-150-170	1	09.028.51.48.0
Plug	1x per hole	09.801.03.53.0
MT-TGRP plate with bolts (from year of manufacture 09.2012)	1	05.801.98.20.0



# BPW height adjustment devices

## Klemmfix 72

(General type approval (German ABE))

The galvanized Klemmfix 72 is a height-adjustment device for drawbar installations that can swivel vertically.

With the optimum setting, the towing eye can be adjusted freely from the horizontal position by at least 300 mm (measured at the towing eye) upwards and downwards. The drawbar installation can be set to the required height by a single person without the need for tools or other assistance. Without a height support device, the Klemmfix 72 can only be used for limited height adjustment. For a drawbar weight of more than 75 kg, a height support device (e.g. return spring with

clamp lock or spring washers) must also be fitted, which will take some of the weight of the drawbar (see diagram). See the assembly and operation instructions for further information.

**BPW NO.:**

Klemmfix 72/Z (tension) 51.98.01.0013

Klemmfix 72/D (compression) 51.98.01.0014

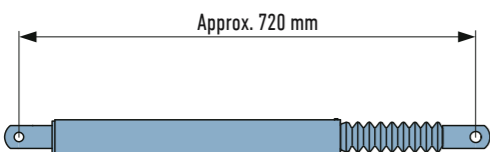

Klemmfix 72/Z

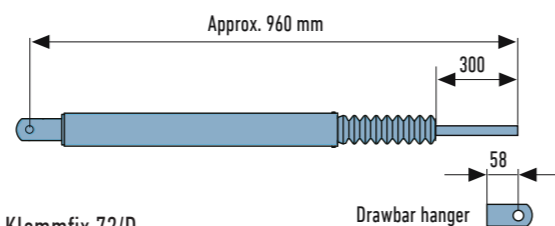

Klemmfix 72/D

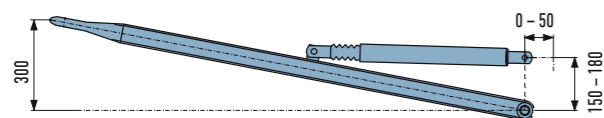

Installation of Klemmfix 72/Z, effective under tension  
Please read the installation and operating instructions.

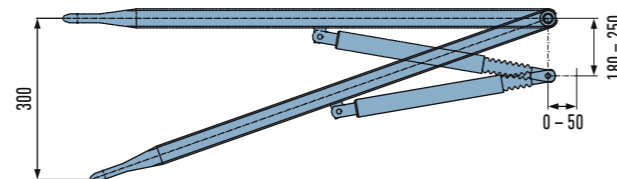

Installation of Klemmfix 72/D, effective under compression  
Please read the installation and operating instructions.

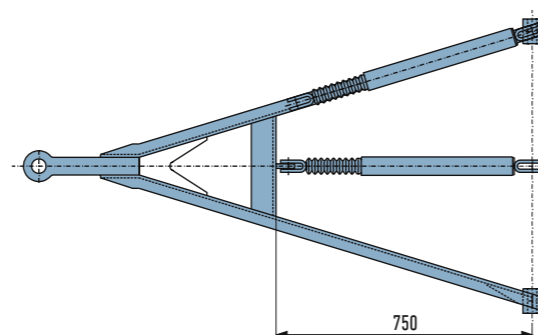

Connection of Klemmfix on longitudinal or cross strut

# BPW height support device

## Compression spring pack

The galvanized compression spring pack are used only as a height support device for Klemmfix 72. The spring washers and Klemmfix 72 work together to enable optimum height adjustment. The spring washers must not be used alone to adjust the height of drawbars.



**BPW NO.:**

Compression spring pack 51.98.03.0001

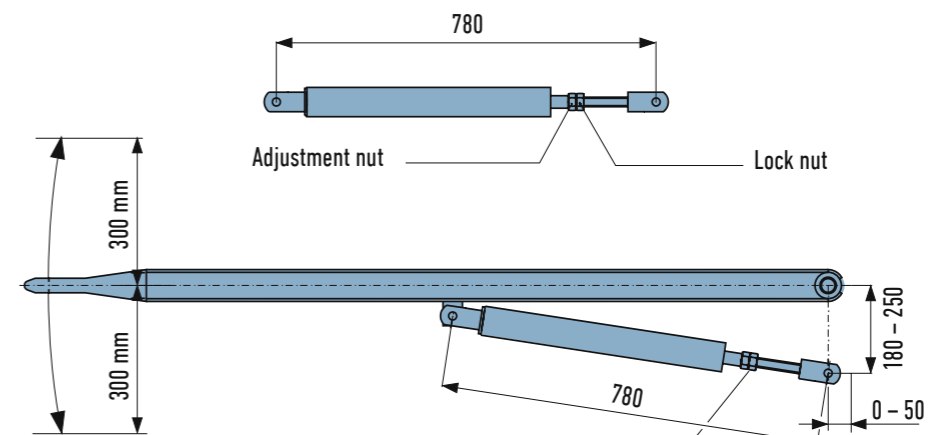

Important:  
Note the spring washers  
installation diagram

# BPW height support device

## Return spring with turnbuckle

The return spring with turnbuckle can be used directly as a height adjustment device. The height is adjusted by turning the turnbuckle. The return spring used means that it is usually sufficient to use one return spring even for heavy drawbars (see diagram). In combination with Klemmfix 72, the return spring with turnbuckle is also used as a height support device.

**BPW NO.:**  
 Return spring (cataphoretic dip-coating – KTL<sub>Zn</sub>) with turnbuckle 09.801.03.18.0  
 Return spring (galvanized) with turnbuckle 09.801.03.83.0

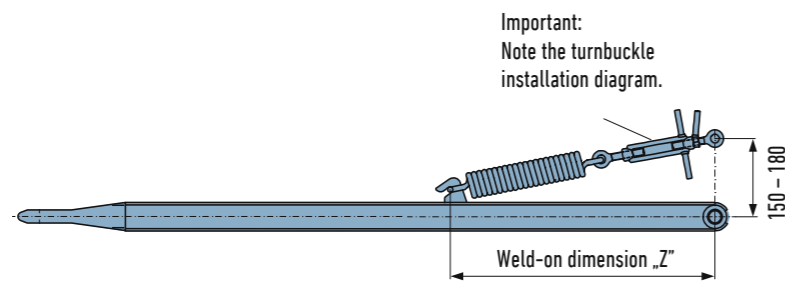
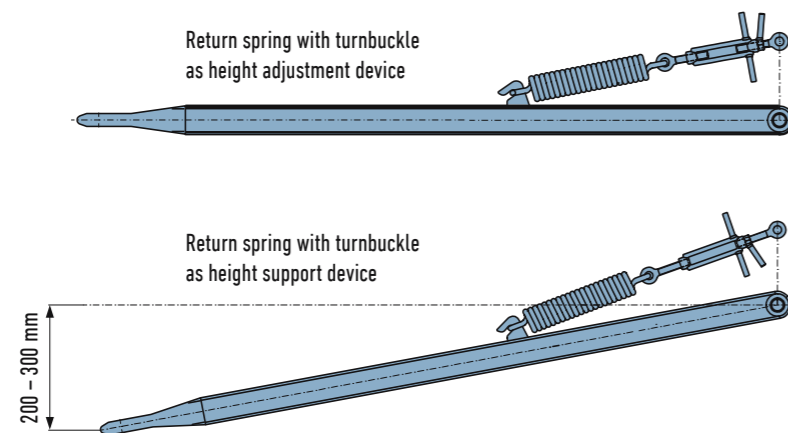
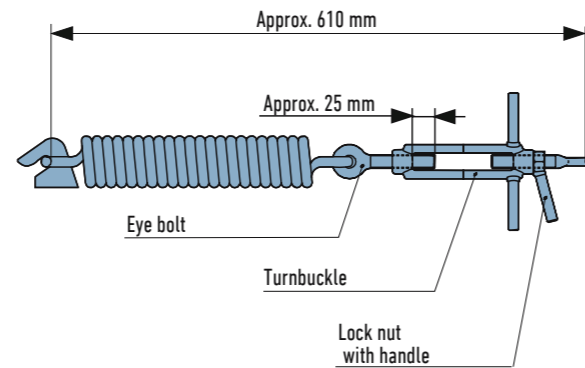

Installation of the return spring with turnbuckle on the drawbar

# BPW height adjustment and support devices

## Choosing the products you need

To select which products are required for height adjustment for the drawbar that is being used, you need the following information:

1. Drawbar length (mm)
2. Drawbar weight (kg)

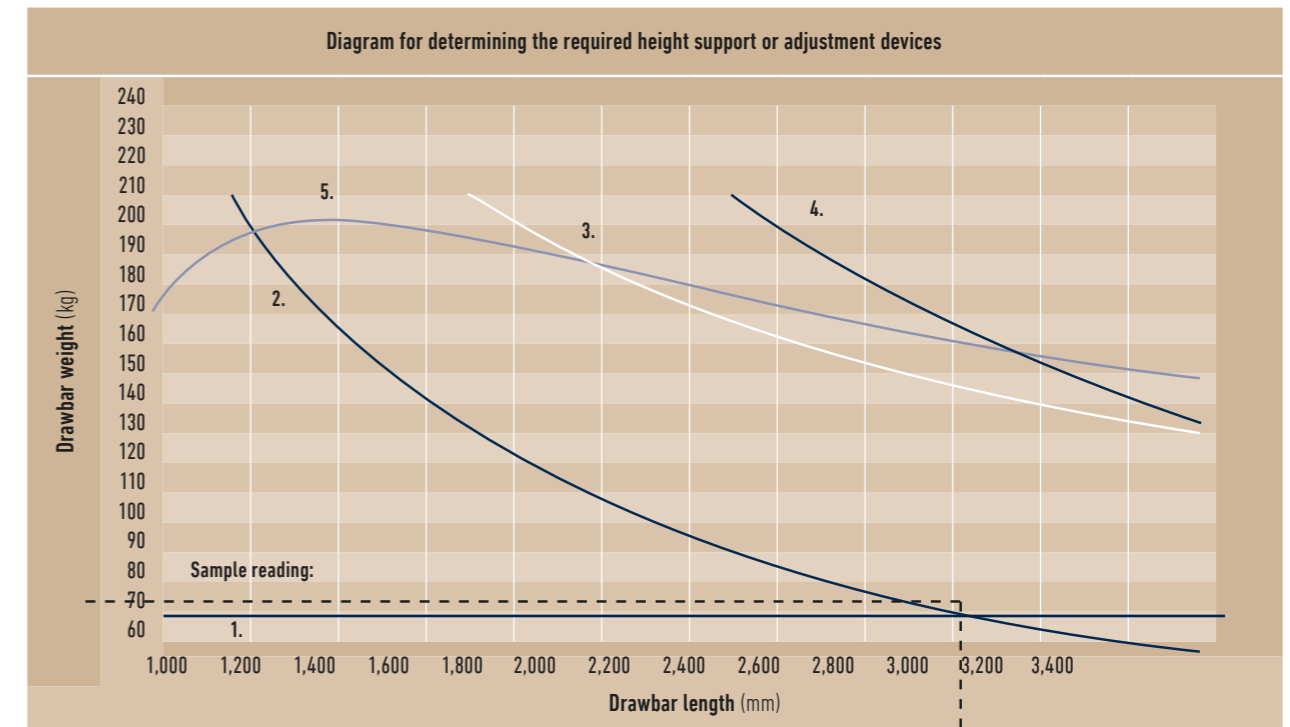

The following combinations can be selected using the diagram:

COMBINATION	HEIGHT ADJUSTMENT DEVICE	HEIGHT SUPPORT DEVICE
1.	Klemmfix 72 <sup>1)</sup>	-
2.	A return spring	-
3.	Klemmfix 72	A return spring
4.	A return spring	A return spring
5.	Klemmfix 72	Spring washers

**Sample reading:**

Drawbar: PZM L = 3,000 mm m = 103 kg

The diagram above shows the combination options 3, 4 and 5 (see table).

<sup>1)</sup> Can only be used alone for drawbars up to 75 kg