

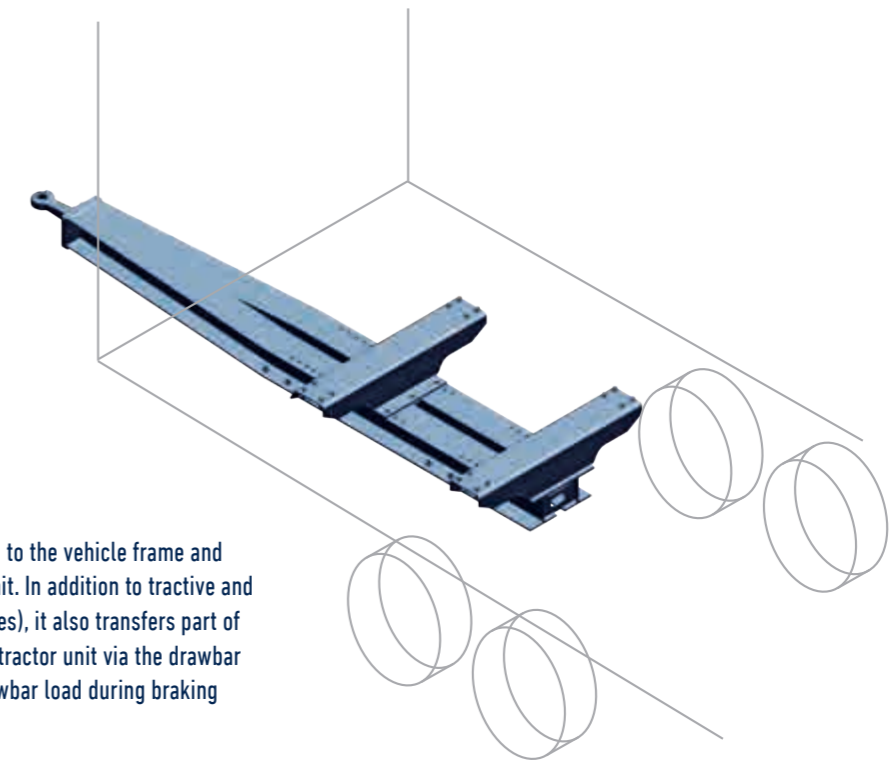

## For assembly on the trailer. Rigid drawbars from BPW.

The BPW rigid drawbar is a drawbar installation for centre axle drawbar trailers that is installed on the vehicle frame of the trailer. It is designed for centre axle drawbar trailers with a permissible

gross weight of 6 to 24 t and provides a reliable drawbar assembly for conventional transport.



The rigid drawbar is connected to the vehicle frame and forms the link to the tractor unit. In addition to tractive and braking forces (horizontal forces), it also transfers part of the gross trailer weight to the tractor unit via the drawbar load and also the dynamic drawbar load during braking (vertical forces).

### BPW RIGID DRAWBARS – FEATURES AND BENEFITS

- ▶ For centre axle drawbar trailers with a permissible gross weight of 6 to 24 t
- ▶ Drawbar load up to 2,500 kg
- ▶ Various versions are available:
  - Rigid, length-adjustable or height-adjustable
  - Different towing eye types
  - Special versions for higher tonnages
- ▶ With ECE approval or individual certificate
- ▶ Treated with zinc phosphate, with cataphoretic dip-coating (KTL<sub>zn</sub>)
- ▶ Expert advice and calculation of characteristic values (e.g. for optimum matching of the BPW hitch block and the BPW rigid drawbar)
- ▶ High level of corrosion resistance due to galvanised inner tubes in drawbars with variable length

# BPW rigid drawbars up to 24,000 kg

## ZD series, rigid

(ECE approval)

In addition to the standard dimensions shown in the tables below, the following options are also available on request:

- Special versions with a higher V value
- Use of other towing eye types
- Other dimensions

Please see the data sheet on our website for further information.

Please note that the permissible Dc and V values of the rigid drawbar must be tailored to the desired towing eye and trailer coupling.

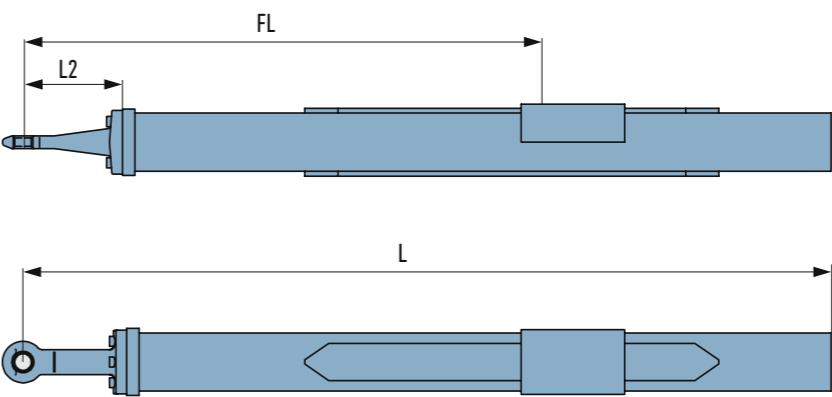

TYPE	TOWING EYE (DIN) L2 (mm)	TOTAL LENGTH L (mm)	MAX. FREE DRAWBAR LENGTH FL (mm)	MAX. V VALUE (kN)	BPW NO.	WEIGHT (kg)
ZD 06 Dc=35 kN 6 t Drawbar load 500 kg Tube 160 x 160 With individual certi- ficate	Ø 40 ZE 13/1 DIN 74054-40D L2 = 250	2,900	1,700	15.3	51.31.06.0100	87
		3,200	1,800	14.1	51.31.06.0101	94
			1,900	13.1		
			2,000	12.2		
		3,500	2,100	11.4	51.31.06.0102	101
			2,200	10.7		
			2,300	10.0		
		3,800	2,400	9.4	51.31.06.0103	108
			2,500	8.8		
			2,600	8.3		
ZD 10-1 <sup>1)</sup> Dc=70 kN 10 t Drawbar load 1,000 kg Tube 140 x 140 ECE no. E1-55R-012555	Ø 40 ZE 13/1 DIN 74054-40D L2 = 250	2,900	1,700	30.8	51.31.10.0100	142
		3,200	1,800	28.5	51.31.10.0101	156
			1,900	26.5		
			2,000	24.7		
		3,500	2,100	23.0	51.31.10.0102	169
			2,200	21.5		
			2,300	20.2		
		3,800	2,400	18.9	51.31.10.0103	182
			2,500	17.8		
			2,600	16.7		
ZD 13,5-1 <sup>2)</sup> Dc=90 kN 13.5 t Drawbar load 1,000 kg Tube 160 x 160 ECE no. E1-55R-012553	Ø 40 ZE 13/1 DIN 74054-40D L2 = 250	2,900	1,700	48.9	51.31.14.0100	165
		3,200	1,800	43.6	51.31.14.0101	182
			1,900	42.7		
			2,000	40.1		
		3,500	2,100	37.7	51.31.14.0102	199
			2,200	35.5		
			2,300	33.6		
		3,800	2,400	31.8	51.31.14.0103	214
			2,500	30.1		
			2,600	28.6		

<sup>1)</sup> Also available cranked 150 mm on request. <sup>2)</sup> Also available cranked on request.  
For use of other towing eye types, see page 36.  
Additional U-bolt for tube 140 x 140, 03.114.00.02.0  
Additional U-bolt for tube 160 x 160, 03.114.00.01.0  
Additional U-bolt for tube 250 x 150, 03.114.00.03.0  
Additional U-bolt for tube 220 x 220, 03.114.00.22.0  
Additional U-bolt for tube 260 x 180, 03.114.00.04.0

TYPE	TOWING EYE (DIN) L2 (mm)	TOTAL LENGTH L (mm)	MAX. FREE DRAWBAR LENGTH FL (mm)	MAX. V VALUE (kN)	BPW NO.	WEIGHT (kg)
ZD 18 <sup>3)</sup> Dc=110 kN 18 t Drawbar load 1,000 kg Tube 250 x 150 ECE no. E1-55R-012556	Ø 50 D50-C DIN 74053-50D1 L2 = 250	2,900	1,700	76.5	51.31.18.0124	226
		3,200	1,800	71.7	51.31.18.0118	250
			1,900	67.4		
			2,000	63.5		
		3,500	2,100	60.0	51.31.18.0119	274
			2,200	56.9		
			2,300	54.0		
		3,800	2,400	51.3	51.31.18.0105	294
			2,500	48.9		
			2,600	46.6		

<sup>3)</sup> Also available cranked on request.

TYPE	TOWING EYE (DIN) L2 (mm)	TOTAL LENGTH L (mm)	MAX. FREE DRAWBAR LENGTH FL (mm)	MAX. V VALUE (kN) DRAWBAR LOAD (kg)		BPW NO.	WEIGHT (kg)
				1,000	2,000		
ZD 20-1A Dc=130 kN 24 t Drawbar load 1,000 kg Drawbar load 2,000 kg Tube 220 x 220 ECE no. E1-55R-012557	Ø 50 D50-C DIN 74053-50D1 L2 = 250	2,900	1,700	90.0	75.0	51.31.20.0110	214
		3,200	1,800	90.0	75.0	51.31.20.0114	238
			1,900	90.0	75.0		
			2,000	87.0	75.0		
		3,500	2,100	82.4	72.6	51.31.20.0105	256
			2,200	78.2	68.4		
			2,300	74.4	64.6		
		3,800	2,400	70.9	61.1	51.31.20.0104	277
			2,500	67.7	57.8		
			2,600	64.7	54.9		
ZD 24-1A <sup>4)</sup> Dc=130 kN 24 t Drawbar load 1,000 kg Drawbar load 2,500 kg Tube 260 x 180 ECE no. E1-55R-012558	Ø 50 D50-C DIN 74053-50D1 L2 = 250	2,900	1,700	90.0	75.0	51.31.24.0126	250
		3,200	1,800	90.0	75.0	51.31.24.0120	275
			1,900	87.4	72.7		
			2,000	82.6	67.9		
		3,500	2,100	78.2	63.5	51.31.24.0110	300
			2,200	74.2	59.5		
			2,300	70.5	55.8		
		3,800	2,400	67.2	52.8	51.31.24.0122	325
			2,500	64.1	49.4		
			2,600	61.3	46.5		

<sup>4)</sup> Also available cranked on request.

# BPW rigid drawbars up to 24,000 kg

## ZD series, rigid, bolted on with adjusting rail

(ECE approval)

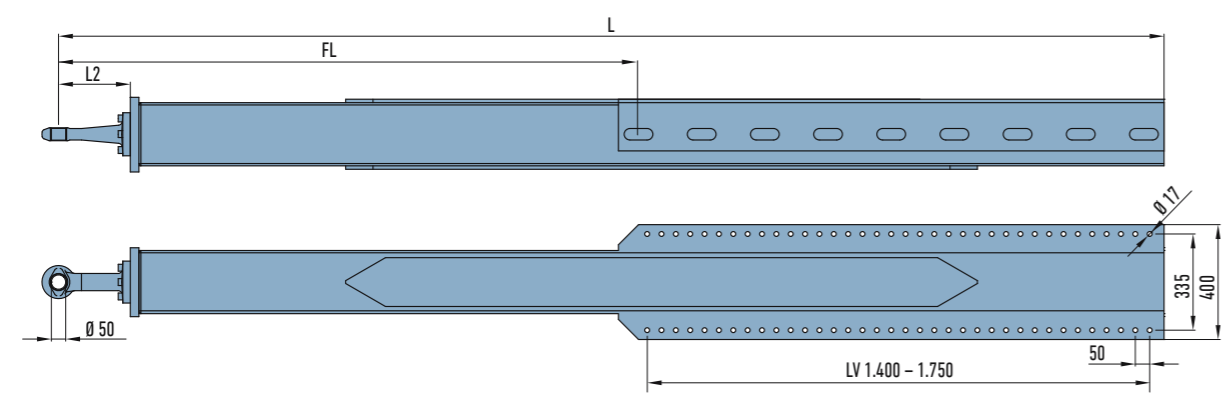

In addition to the standard dimensions shown in the tables below, the following options are also available on request:

- ▶ Special versions with a higher V value
- ▶ Use of other towing eye types
- ▶ Other dimensions

Please see the data sheet on our website for further information.  
Please note that the permissible Dc and V values of the rigid drawbar must be tailored to the desired towing eye and trailer coupling.

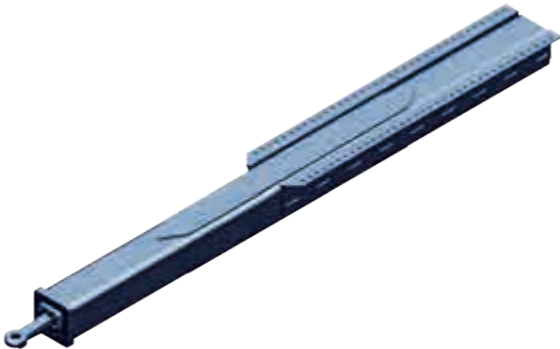

TYPE	TOWING EYE (DIN) L2 (mm)	TOTAL LENGTH L (mm)	MAX. FREE DRAWBAR LENGTH FL (mm)	LENGTH OF ADJUSTING RAIL LV (mm)	MAX. V VALUE (kN) DRAWBAR LOAD (kg) 1,0002,000		BPW NO.	WEIGHT (kg)
ZD 20-1B <sup>1)</sup> Dc = 130 kN 24 t Drawbar load 1,000 kg Drawbar load 2,000 kg Tube 220 x 220 ECE no. E1-55R-012557	Ø 50 D50-C DIN 74053-50D1 L2 = 250	2,900	1,700	1,400 – 1,700 mm	90.0	75.0	51.33.20.0002	260
		3,200	1,800		90.0	75.0	51.33.20.0004	297
			1,900		90.0	75.0		
			2,000		87.0	75.0		
		3,500	2,100	Drilling pattern 335 x 50 x Ø 17	82.4	72.6	51.33.20.0003	315
			2,200		78.2	68.4		
			2,300		74.4	64.6		
		3,800	2,400		70.9	61.1	51.33.20.xxxx	336
			2,500		67.7	57.8		
			2,600		64.7	54.9		

<sup>1)</sup> Combination of ZD20-1B with bolted crossmembers on request (with individual certificate).

# ZD series, rigid, with height offset towing eye

(ECE approval)

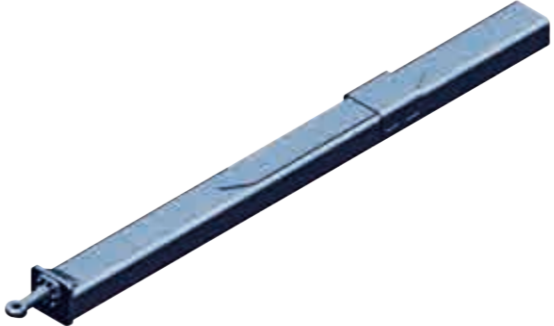
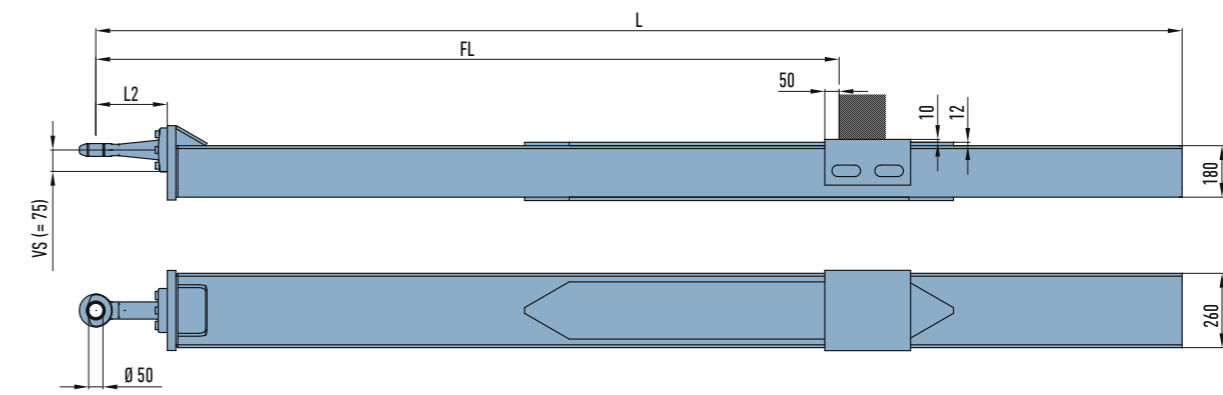

TYPE	TOWING EYE (DIN) L2 (mm)	TOTAL LENGTH L (mm)	MAX. FREE DRAWBAR LENGTH FL (mm)	TOWING EYE OFFSET VS (mm)	MAX. V VALUE (kN)	BPW NO.	WEIGHT (kg)
ZD 24-2A <sup>2)</sup> Dc = 130 kN 24 t Drawbar load 1,000 kg Tube 260 x 180 ECE no. E1-55R-012558	Ø 50 D50-C DIN 74053-50D1 L2 = 250	2,900	1,700	75 (Standard)	81.2	51.31.24.xxxx	250
		3,200	1,800		81.2	51.31.24.0140	275
			1,900		81.2		
		3,500	2,000		75.0	51.31.24.xxxx	300
			2,100		72.9		
			2,200		69.7		
		3,800	2,300		66.3	51.31.24.0130	325
			2,400		63.1		
			2,500		60.1		
			2,600		57.5		

<sup>2)</sup> The standard height offset of the towing eye is 75 mm. Other special dimensions available on request.

For use of other towing eye types, see page 36. For additional U-bolts, see page 22.

# BPW modular rigid drawbar up to 24,000 kg

## ZDM 20 series, rigid, crossmembers bolted on

The ZDM 20 modular rigid drawbar consists of a rigid drawbar and two bolt-on crossmembers. With minimum supporting width (SW) of 1,100 mm, these can be bolted on every 50 mm.

The as-delivered condition is unmounted. Pre-assembled units are also available on request.

Use of the crossmembers in combination with other series is available on request. (See assembly and operating instructions.)

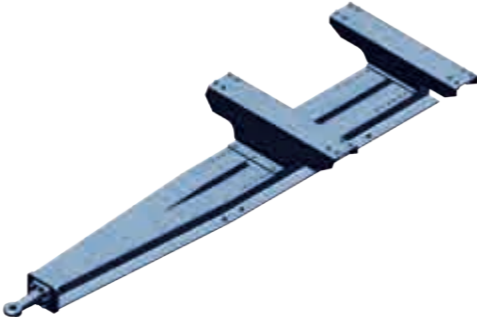

TYPE	TOWING EYE (DIN)	TOTAL LENGTH L (mm)	MAX. FREE DRAWBAR LENGTH FL (mm)	FRAME CENTRE RM (mm)	OVERALL HEIGHT BH (mm)	MAX. V VALUE (kN)	BPW NO.	WEIGHT (including crossmembers, kg)
ZDM 20 Dc = 130 kN 24 t Support width (SW) min. 1,100 mm Drawbar load 1,000 kg HEA profile 180 With individual certificate	Ø 50 D50-C DIN 74053-50D1	3,500	2,100	980	220 270 320 370 420 470 520 570	63.2	51.34.20.0017	388
			2,150			61.5		
			2,200			59.9		
			2,250			58.3		
			2,300			56.8		
		3,800	2,350			55.4	51.34.20.0016	410
			2,400			54.1		
			2,450			52.8		
			2,500			51.5		
			2,550			50.3		
		4,200	2,600			49.2	51.34.20.0018	438
			2,650			48.0		
			2,700			47.0		
			2,750			45.9		
			2,800			44.9		
			2,850			44.0		
			2,900			43.1		
			2,950			42.2		
			3,000			41.3		

TYPE	OVERALL HEIGHT BH (mm)	FRAME CENTRE RM (mm)			
		980	1,100	1,200	1,300
Crossmember set Front/rear for ZDM 20	220	09.801.22.98.0	09.801.22.11.0	09.801.22.12.0	09.801.22.13.0
	270	09.801.27.98.0	09.801.27.11.0	09.801.27.12.0	09.801.27.13.0
	320	09.801.32.98.0	09.801.32.11.0	09.801.32.12.0	09.801.32.13.0
	370	09.801.37.98.0	09.801.37.11.0	09.801.37.12.0	09.801.37.13.0
	420	09.801.42.98.0	09.801.42.11.0	09.801.42.12.0	09.801.42.13.0
	470	09.801.47.98.0	09.801.47.11.0	09.801.47.12.0	09.801.47.13.0
	520	09.801.52.98.0	09.801.52.11.0	09.801.52.12.0	09.801.52.13.0
	570	09.801.57.98.0	09.801.57.11.0	09.801.57.12.0	09.801.57.13.0

Crossmember set can be welded on on request.

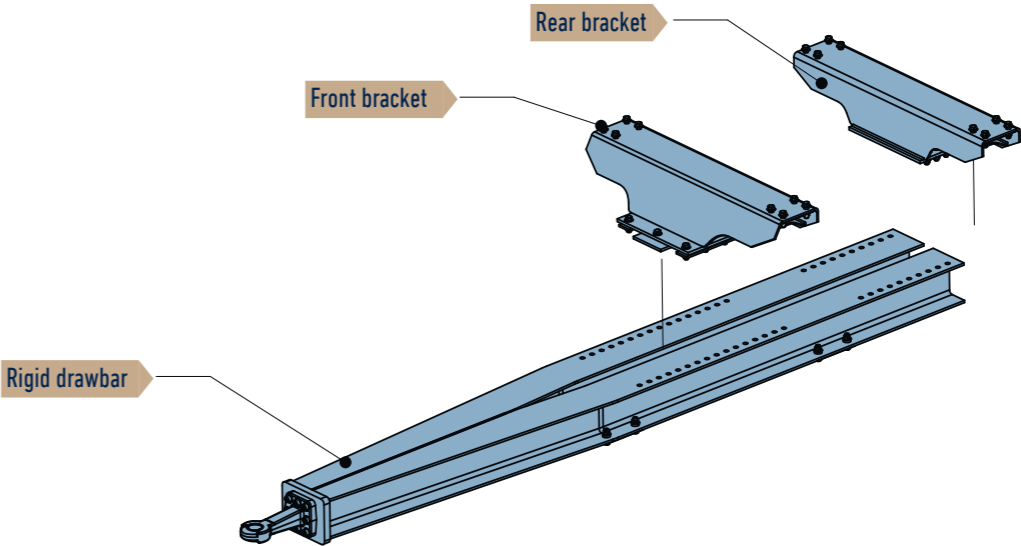
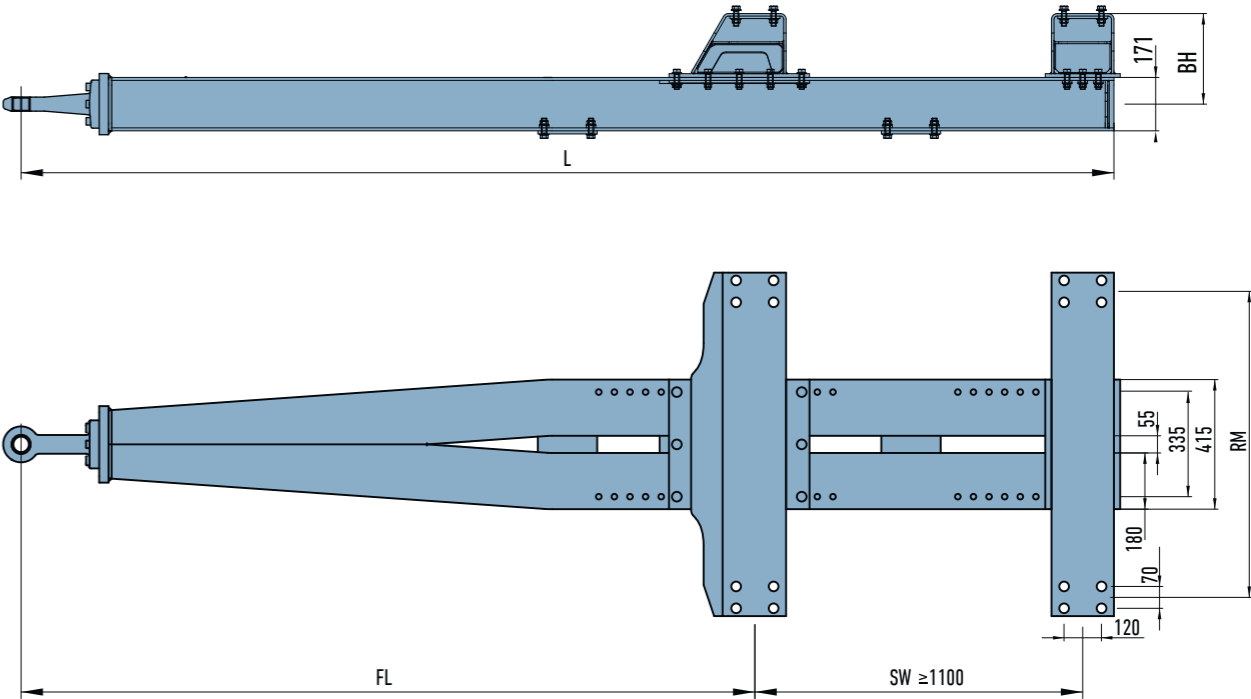

If the brackets (front and rear) are delivered unassembled, they must be bolted on in accordance with the assembly and operating instructions (FL = in accordance with type plate). Characteristic values for rigid drawbar and brackets in accordance with drawbar type plate. The drawbar is only to be used with the brackets from BPW.

# BPW rigid drawbars up to 18,000 kg

## ZEQ series, height adjustable

(Individual certificate)

In addition to the standard dimensions shown in the tables below, the following options are also available on request:

- ▶ Special versions with a higher V value
- ▶ Use of other towing eye types
- ▶ Other dimensions

Please see the data sheet on our website for further information.  
Please note that the permissible Dc and V values of the rigid drawbar must be tailored to the desired towing eye and trailer coupling.

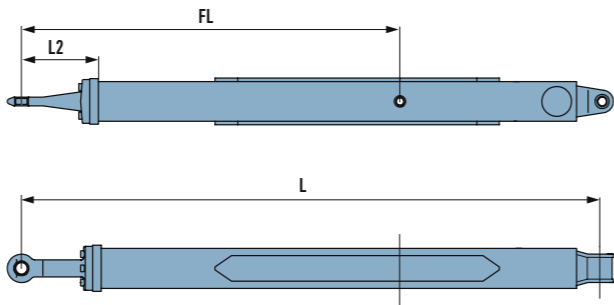

TYPE	TOWING EYE (DIN) L2 (mm)	TOTAL LENGTH L (mm)	MAX. FREE DRAW- BAR LENGTH FL (mm)	MAX. V VALUE (kN)	BPW NO.	WEIGHT (kg)
ZEQ 10-1 Dc = 70 kN 10 t Drawbar load 1,000 kg Tube 140 x 140 With individual certificate	Ø 40 ZE 13/1 DIN 74054-40D L2 = 250	2,990	1,700	30.1	51.32.10.0100	150
		3,290	1,800	28.5	51.32.10.0101	162
			1,900	26.5		
			2,000	24.1		
		3,590	2,100	22.3	51.32.10.0102	174
			2,200	21.5		
			2,300	19.6		
		3,890	2,400	18.4	51.32.10.0103	186
			2,500	17.4		
			2,600	16.2		
ZEQ 13.5 Dc = 90 kN 13.5 t Drawbar load 1,000 kg Tube 160 x 160 With individual certificate	Ø 40 ZE 13/1 DIN 74054-40D L2 = 250	2,990	1,700	46.7	51.32.14.0100	160
		3,290	1,800	43.6	51.32.14.0101	175
			1,900	40.8		
			2,000	38.3		
		3,590	2,100	36.0	51.32.14.0102	190
			2,200	33.9		
			2,300	32.0		
		3,890	2,400	30.2	51.32.14.0103	205
			2,500	28.6		
			2,600	27.1		
ZEQ 18 Dc = 110 kN 18 t Drawbar load 1,000 kg Tube 250 x 150 With individual certificate	Ø 50 D50-C DIN 74053-50D L2 = 250	3,050	1,700	60.5	51.32.18.0105	270
		3,350	1,800	60.5	51.32.18.0108	290
			1,900	60.5		
			2,000	60.5		
		3,650	2,100	57.6	51.32.18.xxxx	310
			2,200	54.6		
			2,300	51.8		
		3,950	2,400	49.2	51.32.18.xxxx	330
			2,500	46.9		
			2,600	44.7		

For use of other towing eye types, see page 36.

# BPW height adjustment device

## for rigid drawbars of the ZEQ 13.5 series

(Individual certificate)

ZEQ 13.5 with height adjustment device – vertical

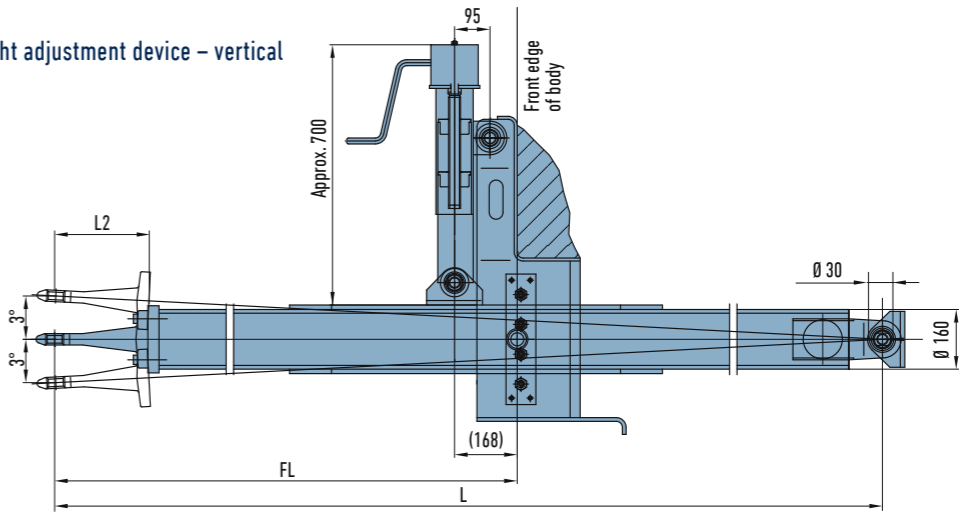

ZEQ 13.5 with height adjustment device – horizontal

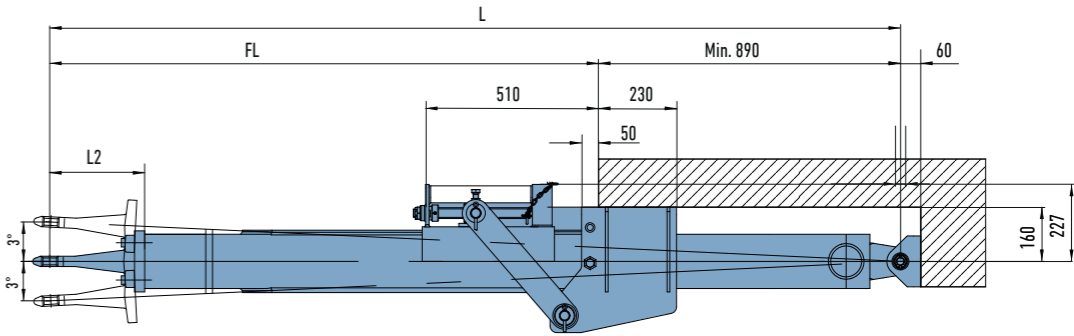

TYPE	DESCRIPTION	QUANTITY per vehicle	BPW NO.	WEIGHT (kg)
Height adjustment device (vertical) for rigid drawbar type ZEQ 13.5-1 (Fig. 1) with individual certificate	For ZEQ 13.5, box including crank spindle, front spring shoe and spring bolt. Info: Rear spring shoe and bolt must be ordered separately	1	05.031.00.18.0	60
Rigid drawbar type ZEQ 13.5-1-HVL (Fig. 2) including height adjustment device (horizontal) with individual certificate	ZEQ 13.5 with box including horizontal spindle, spring shoe and spring bolt L = 2,990, FL = 1,600 – 2,100	1	51.32.15.0101	221
Spring shoe	For bearing eye 100/30 mm	1	02.1004.22.00	3.6
Spring bolt E 11	M 24 x 1.5, with castle nut, washer, split pin and grease nipple	1	09.801.98.18.0	1

# BPW rigid drawbars up to 24,000 kg

## ZFL20 series, length adjustable

(ECE approval)

In addition to the standard dimensions shown in the tables below, the following options are also available on request:

- ▶ Adjustment up to 6 x 100/8 x 100 mm
- ▶ Special adjustment for through-loading operation
- ▶ Special versions with higher V value
- ▶ Use of other towing eye types
- ▶ Other dimensions

As standard, the length-adjustable BPW ZFL20 rigid drawbar features **handle adjustment of 4 x 100 mm**. Pneumatic adjustment is available on request (can also be retrofitted). The stated V values are for the adjustment 0 mm (basic state) and 4 x 100 mm.

Please note that the permissible Dc and V values of the rigid drawbar must be tailored to the desired towing eye and trailer coupling.

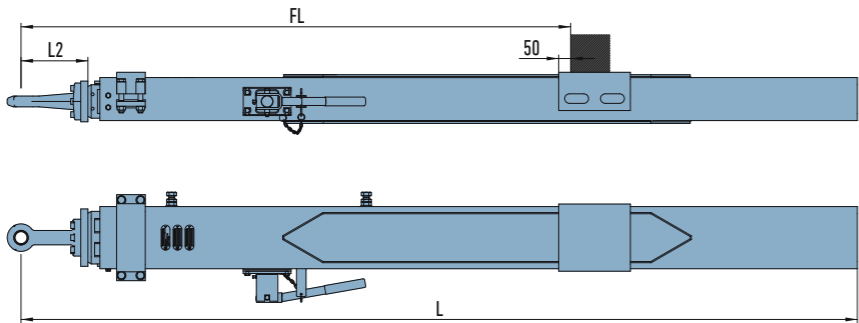

TYPE	TOWING EYE (DIN) L2 (mm)	TOTAL LENGTH L (MM)	MAX. FREE DRAWBAR LENGTH FL (mm)	MAX. V VALUE FOR ADJUSTMENT 0/4 X 100 (kN) DRAWBAR LOAD (kg)		BPW NO.	WEIGHT (kg)
				1,000	2,000		
ZFL20-1A Drawbar load 1,000 kg ZFL20-3A Drawbar load 2,000 kg Dc = 130 kN 24 t Tube 260 x 180 with weld-in U-bolt ECE no. E1-55R-012554	Ø 50 D50-C DIN 74053-50D1 L2 = 280	2,900	1,700	90/76	75/66	51.21.21.xxxx	350
		3,200	1,800	90/76	75/66		375
			1,900	90/73	75/63		
		3,500	2,000	86/70	75/60		405
			2,100	81/66	71/57		
			2,200	77/63	67/54		
		3,800	2,300	73/61	63/51		430
			2,400	70/58	60/48		
			2,500	66/56	57/46		
			2,600	63/54	54/44		

Alternative versions available on request. For towing eyes, see page 36.  
Additional weld-in U-bolt 03.114.00.04.0  
Supplementary installation kit for pneumatic locking 09.801.95.37.0  
Supplementary installation kit for manual locking 09.801.90.71.0

# ZFL20 series, length-adjustable,

## inner tube extended 350 mm in basic position

(ECE approval)

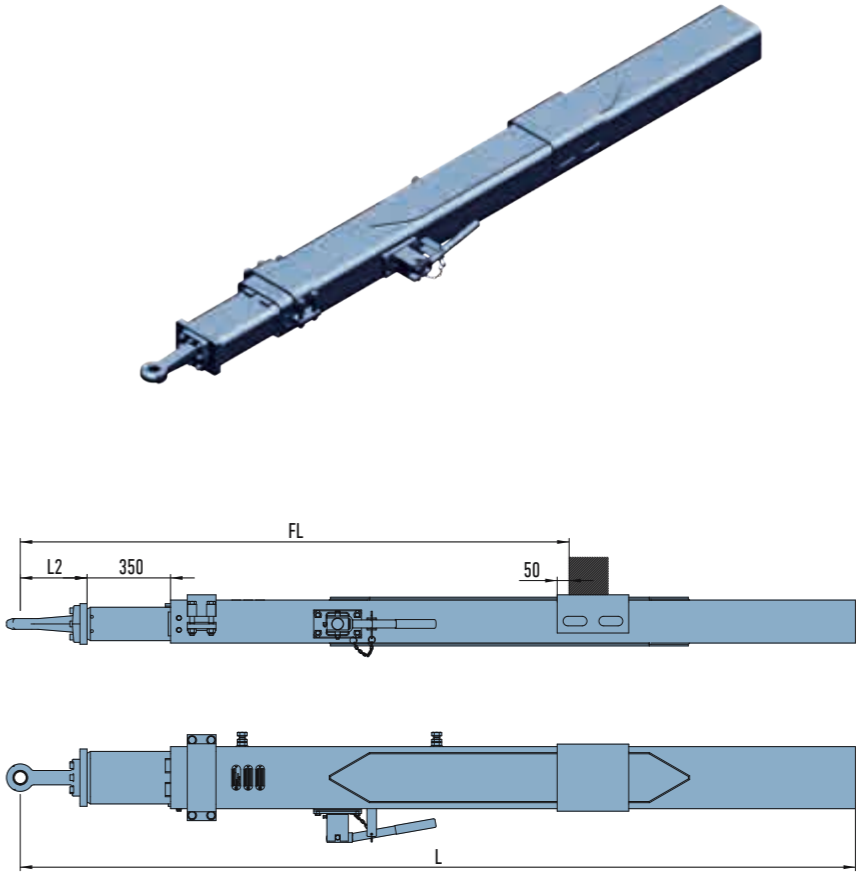

TYPE	TOWING EYE (DIN) L2 (mm)	TOTAL LENGTH L (mm)	MAX. FREE DRAWBAR LENGTH FL (mm)	MAX. V VALUE FOR ADJUSTMENT 0/4 X 100 (kN) DRAWBAR LOAD (kg)		BPW NO.	WEIGHT (kg)
				1,000	2,000		
ZFL20-1A/A Drawbar load 1,000 kg ZFL20-3A/A drawbar load 2,000 kg Inner tube extended 350 mm in basic position Dc = 130 kN 24 t Tube 260 x 180 with weld-in U-bolt ECE no. E1-55R-012554	Ø 50 D50-C DIN 74053-50D1 L2 = 280	2,900	1,700	86/55	75/45	51.21.21.xxxx	335
		3,200	1,800	80/55	70/45		360
			1,900	80/55	70/45		
		3,500	2,000	80/55	70/45		390
			2,100	68/52	58/42		
			2,200	68/52	58/42		
			2,300	68/52	58/42		
		3,800	2,400	59/48	49/38		415
			2,500	59/48	49/38		
			2,600	59/48	49/38		

Alternative versions available on request. For towing eyes, see page 36.  
Additional weld-in U-bolt 03.114.00.04.0  
Supplementary installation kit for pneumatic locking 09.801.95.37.0  
Supplementary installation kit for manual locking 09.801.90.71.0

# BPW rigid drawbars up to 24,000 kg

## ZFL20 series, length-adjustable, bolted on with adjusting rail

(ECE approval)

In addition to the standard dimensions shown in the tables below, the following options are also available on request:

- ▶ Adjustment up to 6 x 100/8 x 100 mm
- ▶ Special adjustment for through-loading operation
- ▶ Special versions with higher V value
- ▶ Use of other towing eye types
- ▶ Other dimensions

As standard, the length-adjustable BPW ZFL20 rigid drawbar features **handle adjustment of 4 x 100 mm**. Pneumatic adjustment is available on request (can also be retrofitted). The stated V values are for the adjustment 0 mm (basic state) and 4 x 100 mm.



Please note that the permissible Dc and V values of the rigid drawbar must be tailored to the desired towing eye and trailer coupling.

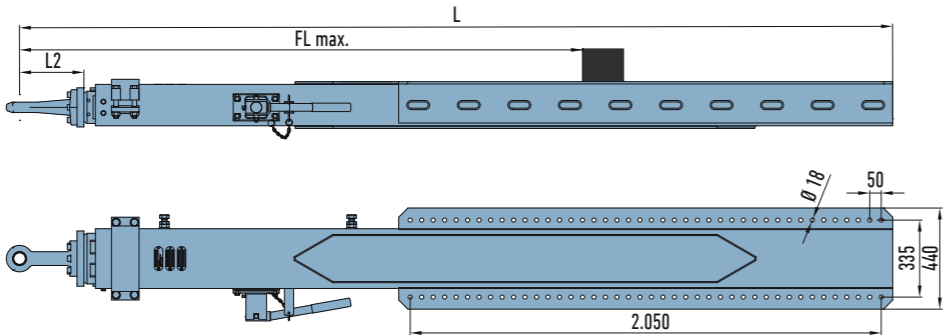

TYPE	TOWING EYE (DIN) L2 (mm)	TOTAL LENGTH L (MM)	MAX. FREE DRAWBAR LENGTH FL (mm)	LENGTH OF AD- JUSTING RAIL LV (mm)	MAX. V VALUE FOR ADJUSTMENT 0/4 X 100 (kN)		BPW NO.	WEIGHT (kg)
					1,000	2,000		
ZFL20-1B Drawbar load 1,000 kg	Ø 50 D50-C DIN 74053-50D1 L2 = 280	3,800	1,950	Drilling pattern 2050 x 335 x 50 x Ø 18	88/71	75/61	51.21.21.xxxx	505
ZFL20-3B Drawbar load 2,000 kg			2,000		86/70	75/60		
Dc = 130 kN			2,100		81/66	71/57		
24 t			2,200		77/63	67/54		
Tube 260 x 180			2,300		73/61	63/51		
With adjusting rail		4,100	2,400		70/58	60/48		530
Minimum support width			2,500		66/56	57/46		
SW = 1,200 mm			2,600		63/54	54/44		
EC no.: E4*94/20*1141*01			2,700		61/52	51/42		
			2,750		59/51	49/41		

Alternative versions available on request. For towing eyes, see page 36.  
Supplementary installation kit for pneumatic locking 09.801.95.37.0  
Supplementary installation kit for manual locking 09.801.90.71.0

# ZFL20 series, length adjustable, with height offset of the towing eye

(ECE approval)

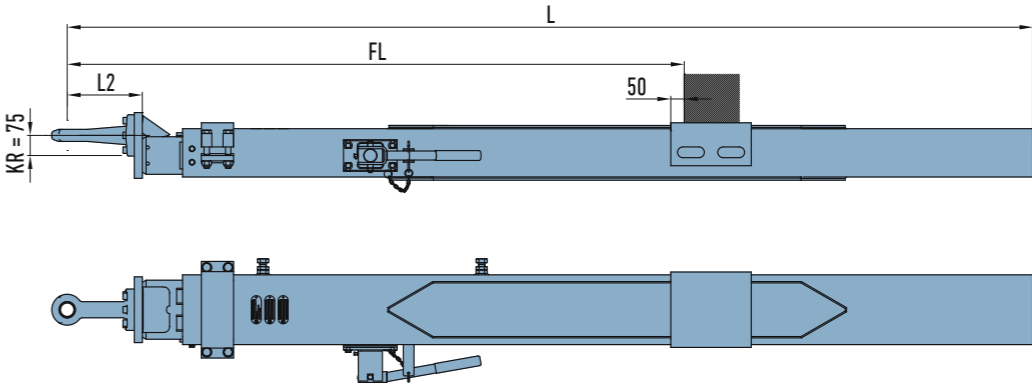

TYPE	TOWING EYE (DIN) L2 (mm)	TOTAL LENGTH L (mm)	MAX. FREE DRAWBAR LENGTH FL (mm)	TOWING EYE OFFSET VS (MM)	MAX. V VALUE FOR ADJUSTMENT 0/4 X 100 (kN)	BPW NO.	WEIGHT (kg)
ZFL20-2A Drawbar load 1,000 kg With height offset of towing eye Dc = 130 kN 24 t Tube 260 x 180 with weld-in U-bolt ECE no.: E1-55R-012554	Ø 50 D50-C DIN 74053-50D1 L2 = 280	3,000	1,700	75 Standard	90/58	51.21.21.xxxx	355
		3,300	1,800		87/58		380
			1,900		82/58		
			2,000		77/58		
		3,600	2,100		73/58		410
			2,200		69/57		
			2,300		66/55		
		3,900	2,400		63/52		435
			2,500		60/50		
			2,600		57/48		

Alternative versions available on request. For towing eye, see page 36.  
Additional weld-in U-bolt 03.114.00.04.0  
Supplementary installation kit for pneumatic locking 09.801.95.37.0  
Supplementary installation kit for manual locking 09.801.90.71.0

# BPW modular rigid drawbars up to 24,000 kg

## ZFL20 series, length adjustable

### with bolted crossmembers

(Individual certificate)

The rigid drawbars in the ZFL20 series can also be supplied as modular systems with crossmembers that can be bolted. With a minimum support width (SW) of 1,200 mm, the crossmembers can be bolted on every 50 mm.

The as-delivered condition is unmounted. Pre-assembled units are also available on request.

The stated V values are for the adjustment 0 mm (basic state) and 4 x 100 mm.

Please note that the permissible Dc and V values of the rigid drawbar must be tailored to the desired towing eye and trailer coupling.

Use of the crossmembers in combination with other series is available on request.

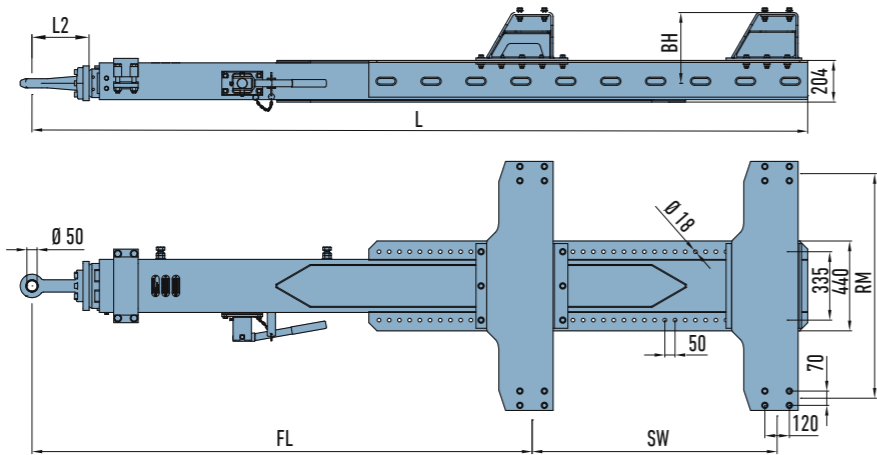

TYPE	TOWING EYE (DIN) L2 (mm)	TOTAL LENGTH L (mm)	MAX. FREE DRAWBAR LENGTH FL (mm)	ADJUSTING RAIL LV (mm)	FRAME CENTRE RM (mm)	OVERALL HEIGHT BH (mm)	V VALUE FOR ADJUSTMENT 0/4 X 100 (kN)	WEIGHT FOR FRAME CENTRE (RM) = 1,100 BH = 346 (kg)
ZFL20-1B With bolted crossmembers Drawbar load 1,000 kg Dc = 130 kN 24 t Tube 260 x 180 With adjusting rail Minimum support width SW = 1,200 mm In modular design With individual certificate	Ø 50 D50-C DIN 74053-50D1 L2 = 280	3,800	1,950	Drilling pattern 2050 x 335 x 50 x Ø 18	980	246	88/71	685
			2,000				86/70	
			2,100				81/66	
			2,200				77/63	
			2,300				73/61	
			2,400				70/58	
		4,100	2,500		1,200	466	710	
			2,600		1,300	496		
			2,700		546	63/54		
			2,750		596	61/52		
						59/51		

Alternative versions available on request. For towing eyes, see page 36.  
Supplementary installation kit for pneumatic locking 09.801.95.37.0  
Supplementary installation kit for manual locking 09.801.90.71.0

# BPW rigid drawbars up to 13,500 kg

## ZFL13.5 series, length adjustable

(Individual certificate)

With the ZFL13.5, BPW also offers a length-adjustable drawbar for vehicles up to 13.5 t permissible gross weight. In addition to the standard dimensions shown in the tables below, the following options are also available on request:

- ▶ Adjustment up to 6 x 100/8 x 100 mm
- ▶ Special adjustments
- ▶ Use of other towing eye types
- ▶ Other dimensions

**As standard**, the length-adjustable BPW ZFL13.5 rigid drawbar features **handle adjustment of 4 x 100 mm**. Pneumatic adjustment is available on request (can also be retrofitted).



The stated V values are for the adjustment 0 mm (basic state) and 4 x 100 mm.

Please note that the permissible Dc and V values of the rigid drawbar must be tailored to the desired towing eye and trailer coupling.

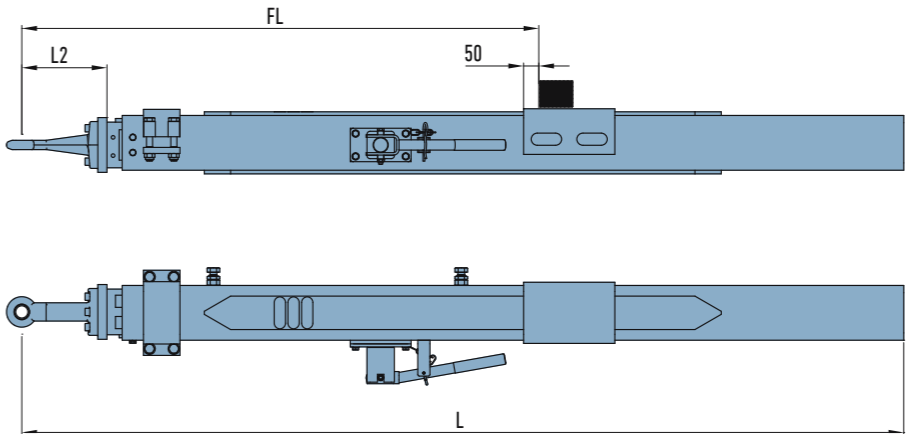

TYPE	TOWING EYE (DIN) L2 (mm)	TOTAL LENGTH L (mm)	MAX. FREE DRAWBAR LENGTH FL (mm)	MAX. V VALUE FOR ADJUSTMENT 0/4 X 100 (kN)	BPW NO.	WEIGHT (kg)
ZFL13.5-1A Drawbar load 1,000 kg Dc = 90 kN 13.5 t Tube 180 x 180 With weld-on U-bolt With individual certificate	Ø 40 ZE 13/1 DIN 74054-40D L2 = 280	2,900	1,700	53/41	51.21.13.xxxx	265
			1,800	50/39		
		3,200	1,900	47/37		280
			2,000	44/35		
		3,500	2,100	41/33		295
			2,200	39/31		
			2,300	37/30		
			2,400	35/28		
		3,800	2,500	33/27		310
			2,600	31/26		

Alternative versions available on request. For towing eyes, see page 36.  
Additional weld-on U-bolt 03.114.76.07.0  
Supplementary installation kit for pneumatic locking 05.801.95.37.0  
Supplementary installation kit for manual locking 09.801.90.71.0

# BPW rigid drawbars – general information

## Towing eyes and bolt-on flanges

With its range of rigid drawbars, BPW offers a comprehensive modular system that enables individual combinations. Below is an overview of the BPW standard product range.

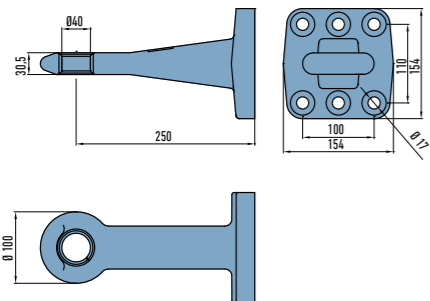

**Towing eye DIN 40 (ZE/13)**  
ECE no. E1-55R-012577  
51.30.14.0002

**Bolt (6 units)**  
02.5015.64.12

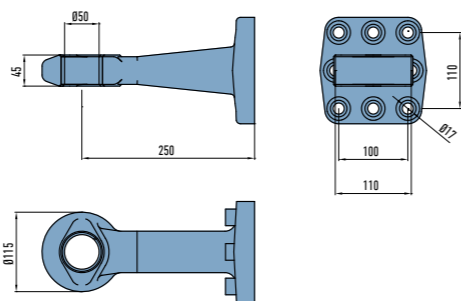

**Towing eye DIN 50 (D50-D1)**  
02.4904.27.00

**Bolt (8 units)**  
02.5015.64.12

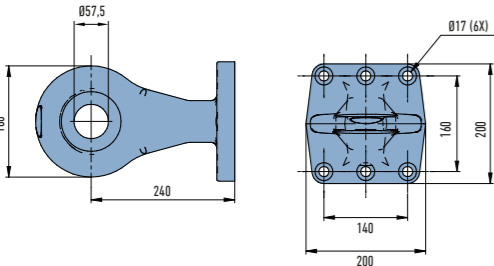

**Towing eye Type VBG-15**  
ECE no. E4-55R-010084  
02.4904.25.00

**Bolt (6 units)**  
02.5015.66.23

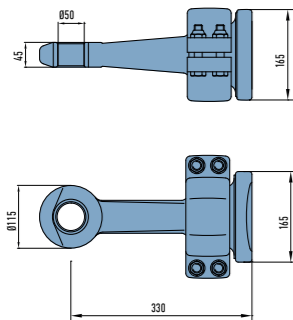

**Towing eye DIN 50 (480)**  
02.4904.17.00

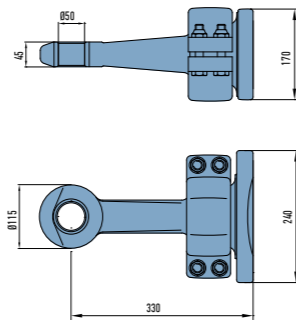

**Towing eye DIN 50 (480/1)**  
02.4904.22.00

# BPW rigid drawbars – general information

## Special versions

In addition to the modular system, BPW also offers a range of individual solutions and can therefore also fulfil specific customer requirements. Below is a selection from the special design range.

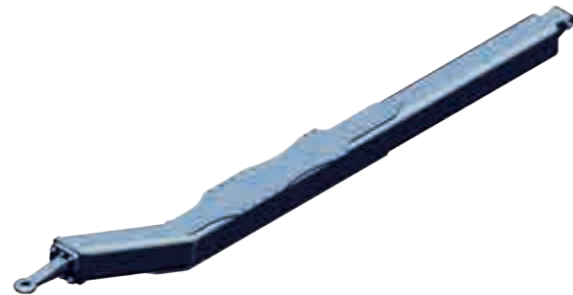

ZDK series

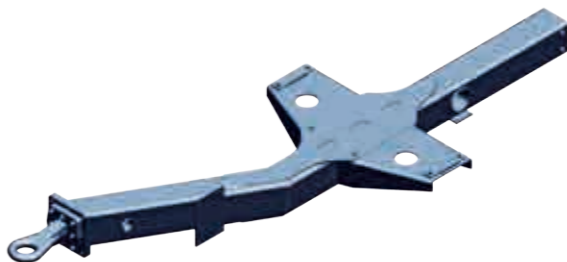

ZDK series with crossmember



ZFLK series



ZFL series

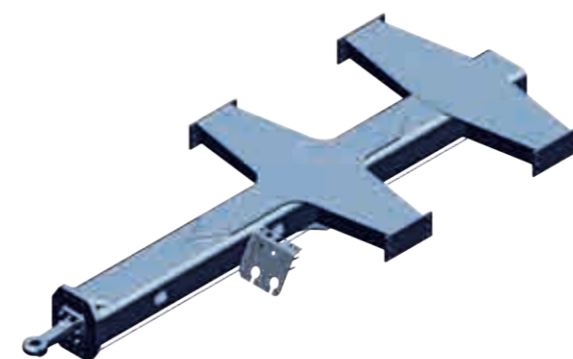

ZD series with crossmembers

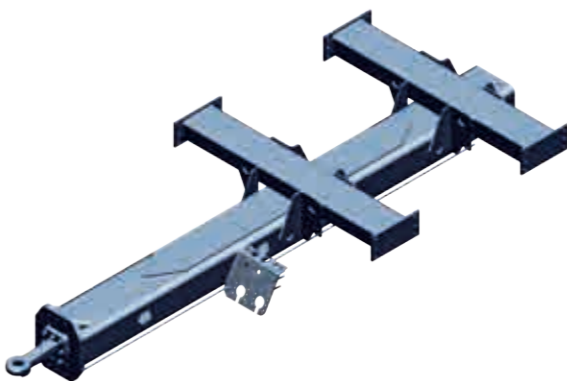

ZD series with crossmembers